

# ASSEMBLY INSTRUCTIONS

## ASSEMBLY FOR FRESH AIR HOOD / BAROMETRIC RELIEF HOOD ON DOWN DISCHARGE GEAR ECONOMIZER FOR DCC / DCG / DCH 090-150

Fresh Air Hood Parts List			
Item	Part Number	Description	Qty
1	EHS2	Hood Side L & R	2
2	FCH2	Filter Channel	2
3	EHT2	Hood Top	1
4	EHB2	Hood Bottom	1
5	FAP2	Filter Access Panel	1
6	420000066	Mist Eliminator 32 1/4" x 22" x 1"	1

### Step 1:

Using the provided 5/16" screws, attach filter channel ② to the side panels ① of the Fresh Air hood assembly.

### Step 2:

Attach the top of the hood assembly ③ to the two side panels ① with the flanges pointed out.

### Step 3:

Attach the bottom ④ of the hood assembly to the side panels.

### Step 4:

Peel backing from adhesive gasket and attach to the flanges of the hood assembly, overlap to provide a weather tight seal when hood is attached to the economizer/RTU.

### Step 5:

Attach the assembled hood to the economizer/RTU above the barometric relief hood.

### Step 6:

Slide the mist eliminator ⑥ into the filter channel inside the hood.

### Step 7:

Attach the mist eliminator access panel ⑤ to the front of the fresh air hood.

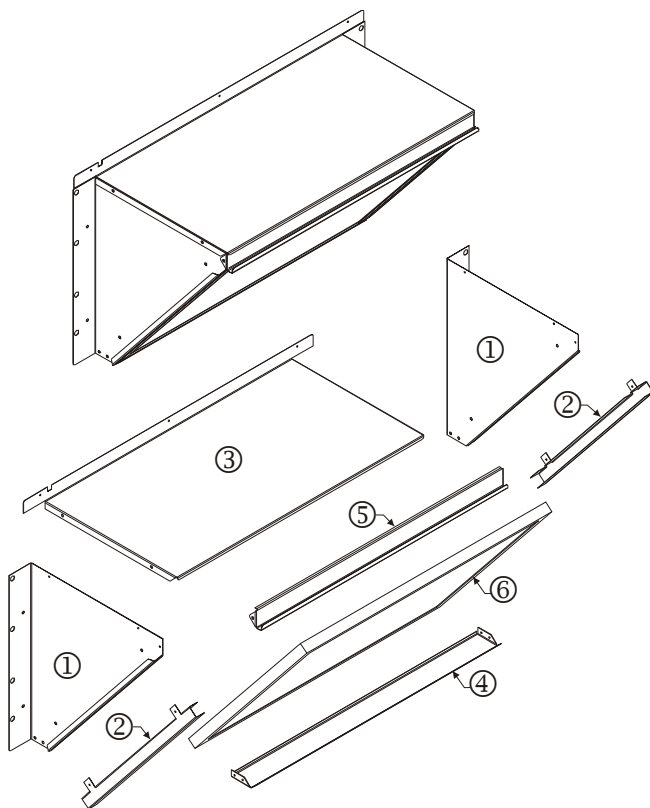

Barometric Relief Hood Parts List			
Item	Part Number	Description	Qty
1	EHS	Hood Side L & R	2
2	FCH	Filter Channel	2
3	EHT	Hood Top	1
4	EHB	Hood Bottom	1
5	FAP	Filter Access Panel	1
6	PERF	Perforated Bird Screen	2
7	BRFA	Barometric Relief Frame Assembly	1

### Step 1:

Using the provided 5/16" screws, attach filter channel ② to the side panels ① of the barometric hood assembly.

### Step 2:

Attach the top of the hood assembly ③ to the two side panels ① with the flanges pointed out.

### Step 3:

Attach the barometric relief frame assembly ⑦ to the side panels using provided 5/16" screws. Make sure the damper assembly lines up with predrilled holes and that the damper blades open out before attaching.

### Step 4:

Attach the bottom ④ of the hood assembly to the side panels.

### Step 5:

Peel backing from adhesive gasket and attach to the flanges of the barometric hood assembly, overlap to provide a weather tight seal when hood is attached to the economizer/RTU.

### Step 6:

Attach the assembled barometric relief hood to the economizer/RTU beneath the fresh air hood.

### Step 7:

Slide the perforated bird screen ⑥ into the channel inside the hood.

### Step 8:

Attach the filter access panel ⑤ to the front of the fresh air hood.

