

TurboTorch®

Cutting and Brazing Tools



TurboTorch®

TurboSkill
by TurboTorch®



Contents

Air Acetylene	4
Propane and Mapp®	9
Oxygen Acetylene	15
Regulators and Kits	18
TurboTotes®	19
Turbo Cylinders and Tanks	20
Accessories	21
Plasma Cutting Systems	22
Oxy/Fuel Kits Cutting Welding and Brazing	23
Hand Torches and Purging Kits	24
Cross Reference	25
ServiceFirst Item No. to Manufacturer No.	25
Manufacturer No. to ServiceFirst Item No.	26

Air Acetylene

Swirl Air Acetylene Kits



- KIT08306**
X-5B Kit (0386-0338)
 Flexible lighter-duty kit.
- Components:**
- AR-B (CGA 520) Regulator
 - G-4 Handle
 - A-5 Tip
 - AH-12 Hose
 - Soft solders to 1-1/2 in. (40 mm)
 - Silver brazes to 3/4 in. (20 mm)
 - "B" Tank connection
 - Instruction manual



- KIT08307**
X-6MC Kit (0386-0339)
 All-purpose kit for work using "MC" tank.
- Components:**
- AR-MC (CGA 200) Regulator
 - G-4 Handle
 - AH-12 Hose
 - A-3 Tip
 - A-8 Tip
 - Soft solders to 2 in. (50 mm)
 - Silver brazes to 1 in. (30 mm)
 - "MC" Tank connection
 - Instruction manual



- KIT08348**
X-3B Kit (0386-0335)
 Flexible kit brazes light and medium gauge steel.
- Components:**
- AR-B (CGA 520) Regulator
 - G-4 Handle
 - AH-12 Hose
 - A-3 Tip
 - A-11 Tip
 - Soft solders to 3 in. (75 mm)
 - Silver brazes to 1-5/8 in. (40 mm)
 - "B" Tank connection
 - Instruction manual



- KIT08349**
X-4B Kit (0386-0336)
 Higher capacity kit brazes medium and heavy gauge steel.
- Components:**
- AR-B (CGA 520) Regulator
 - G-4 Handle
 - AH-12 Hose
 - A-5 Tip
 - A-14 Tip
 - Soft solders to 3-1/2 in. (90 mm)
 - Silver brazes to 2 in. (50 mm)
 - "B" Tank connection
 - Instruction manual

Air Acetylene

Swirl Air Acetylene Kits



KIT08338
PL-5ADLX-MC Kit (0386-0832)

Components:

- AR-MC (CGA-200) Regulator
- G4 Handle
- AH-12 Hose
- PL-5A Tip
- Soft solders to 1-1/2 in. (40 mm)
- Silver brazes to 3/4 in. (20 mm)
- "MC" Tank connections
- Instruction manual

KIT08308
PL-5ADLX-B Kit (0386-0833)
 (Not Shown) "B" Tank connection



KIT08309
PL-8ADLX-MC Kit (0386-0834)

Components:

- AR-MC (CGA-200) Regulator
- G4 Handle
- AH-12 Hose
- PL-8A Tip
- Soft solders to 2 in. (50 mm)
- Silver brazes to 1 in. (30 mm)
- "MC" Tank connections
- Instruction manual

KIT08351
PL-8ADLX-B Kit (0386-0835)
 (Not Shown) "B" Tank connection



KIT08339
PL-12ADLX-B (0386-0836)

Components:

- AR-B (CGA-520) Regulator
- G4 Handle
- AH-12 Hose
- PL-12A Tip
- Soft solders to 3-1/2 in. (90 mm)
- Silver brazes to 2 in. (50 mm)
- "B" Tank connections
- Instruction manual



KIT08342
PLF-5A-DLX-B (0386-0865)

KIT08343

PLF-8A-DLX-MC (0386-0866)
 (Not Shown)

KIT08344

PLF-8A-DLX-B (0386-0867)
 (Not Shown)

Air Acetylene

Swirl Air Acetylene Tips



TIP00131
A-2 (0386-0100)



TIP00142
A-3 (0386-0101)



TIP00143
A-5 (0386-0102)



TIP00144
A-8 (0386-0103)



TIP00145
A-11 (0386-0104)



TIP00146
A-14 (0386-0105)



TIP00132
A-32 (0386-0106)

ServiceFirst Item No.	Mfg. No.	Tip Size		Gas Flow		Copper Tubing Size Capacity				Replacement Orifice Model
		In.	mm	@14 PSI Ft ³ /Hr	(0.9 BAR) M ³ /Hr	Soft Solder		Silver Braze		
						In.	mm	In.	mm	
TIP00131	A-2	1/8	4.8	2.0	.17	1/8-1/2	3-15	1/8-1/4	3-10	OR-A2
TIP00142	A-3	3/16	6.4	3.6	.31	1/4-1	10-25	1/8-1/2	3-12	OR-A3
TIP00143	A-5	1/4	7.9	5.7	.48	3/4-1 1/2	20-40	1/4-3/4	10-20	OR-A5
TIP00144	A-8	5/16	9.5	8.3	.71	1-2	25-50	1/2-1	15-25	OR-A8
TIP00145	A-11	7/16	11.1	11.0	.94	1 1/2-3	40-75	7/8-1 1/8	20-40	OR-A11
TIP00146	A-14	1/2	12.7	14.5	1.23	2-3 1/2	50-90	1-2	30-50	OR-A14
TIP00132	A-32*	3/4	19.0	33.2	2.82	4-6	100-150	1 1/2-4	40-100	OR-A32

*Use with large tank only. NOTE: For air conditioning, add 1/8 in. for type "L" tubing.

Air Acetylene

Swirl Air Acetylene Tips



TIP00147
PL-3A (0386-0874)



TIP00148
PL-5A (0386-0818)



TIP00149
PL-8A (0386-0819)



TIP00150
PL-12A (0386-0820)

ServiceFirst		Tip Size		Gas Flow		Copper Tubing Size Capacity				Replacement Orifice Model	Replacement Tip Ends
				@14 PSI	(0.9 BAR)	Soft Solder		Silver Braze			
Item No.	Mfg. No.	in.	mm	SCFH	m ³ /Hr	in.	mm	in.	mm		
TIP00147	PL-3A	1/4	5.0	3.6	.31	1/4-1	10-25	1/8-1/2	3-12	OR-A3	3A-TE
TIP00148	PL-5A	3/16	6.4	5	.42	3/4-1 1/2	20-40	1/4-3/4	10-20	OR-A8	5A-TE
TIP00149	PL-8A	5/16	7.9	7	.59	1-2	25-50	1/2-1	15-30	ORPL-8A	8A-TE
TIP00150	PL-12A	3/8	9.5	9	.76	2-4	50-90	1-2	25-50	OR-T-6	12A-TE

Note: For air conditioning, add 1/8 in. for type "L" tubing

Air Acetylene

Swirl Air Acetylene Components



HDL00915
G-4 TurboTorch Handle (0386-0308)
Ergonomically designed handle with valve and quick disconnect. Fits all Proline and TurboTorch tips. "A" size 3/8 in.-24 hose connection.



**Now Includes
Gauge Guard**

Acetylene Regulators
REG00433 AR-B (0386-0725)
REG00440 AR-MC (0386-0726)
Brass construction, adjustable with contents gauge. AR-B (CGA-520), fits "B" tank and 3/8 in. 24-thread LH hose nut. AR-MC (CGA-200) fits "MC" tank and 3/8 in. 24-thread LH hose nut.

Propane and Mapp®

Swirl Propane and Mapp® Kits



KIT08305
LP-1 Kit (0386-0247)

Components:

- R-LP Adjustable regulator, CGA-510
- H-4 Handle
- H-12 Hose
- T-4 Tip
- T-6 Tip
- Soft solders to 6 in. (150 mm)
- Silver brazes to 4 in. (100 mm)
- Instruction manual



KIT08340
PL-4TDLX KIT (0386-0838)

Components:

- RL-P Regulator, CGA-510
- H-4 Handle
- H-12 Hose
- PL-4T Tip
- Soft solders 1-1/2 in. (40 mm)
- Silver brazes 3/4 in. (20 mm)
- Instruction manual

Propane and Mapp®

Swirl Propane and Mapp® Tips / Components



TIP00135
T-2 (0386-0150)



TIP00136
T-3 (0386-0151)



TIP00133
T-4 (0386-0152)



TIP00134
T-5 (0386-0153)



TIP00137
T-6 (0386-0154)

TurboTorch Tips

ServiceFirst Item No.	Mfg. No.	Tip Size		Gas Flow		Copper Tubing Size Capacity Propane Gas				Copper Tubing Size Capacity Mapp® Gas				Replacement Orifice Model
		in.	mm	@24 PSI lb/hr	@36 PSI lb/hr	Soft Solder		Silver Braze		Soft Solder		Silver Braze		
						in.	mm	in.	mm	in.	mm	in.	mm	
TIP00135	T-2	5/16	8.0	.14	.17	1/8-1/4	3-10	1/16-1/4	1-6	1/8-1/2	3-12	1/8-1/4	3-10	OR-A2
TIP00136	T-3	7/16	11.1	.20	.25	1/4-1	6-25	1/8-1/2	3-10	1/4-1 1/2	10-40	1/4-1/2	6-15	OR-T3
TIP00133	T-4	1/2	12.7	.39	.48	1/4-1 1/2	10-40	1/4-3/4	6-15	1/4-2 1/2	10-60	1/4-1 1/4	6-35	OR-A3
TIP00134	T-5	3/4	19.0	1.10	1.3	1 1/2-2 1/2	25-60	1/2-1 1/4	15-35	1-4	25-100	1/2-2	15-50	OR-A8
TIP00137	T-6	1	25.4	2.10	2.5	1 1/2-4	40-100	3/4-2	20-50	1 1/2-6	25-150	3/4-4	20-100	OR-T6

Propane and Mapp®

Swirl Propane and Mapp® Tips / Components



TIP00139
PL-4T (0386-0822)

Pro-Line Tips

ServiceFirst		Tip Size		Air Propane @24 PSI lb/hr	Air MAPP® @42 PSI lb/hr	Copper Tubing Size Capacity Propane Gas				Copper Tubing Size Capacity MAPP® GAS				Replacement	
						Soft Solder		Silver Braze		Soft Solder		Silver Braze		Orifice Model	Tip Ends
Item No.	Mfg. No.	in.	mm			in.	mm	in.	mm	in.	mm	in.	mm		
TIP00139	PL-4T	7/16	11.1	.52	.69	1/4-1 1/2	10-40	1/4-3/4	6-15	1/4-2 1/2	10-60	1/4-1 1/4	6-35	OR-PL4T	4T-TE

Soldering and brazing sizes based on propane. Capacity larger on MAPP® GAS.



HDL00916
H-4 Handle
(0386-0300)

Ergonomically designed handle with valve rear and quick disconnect. Fits all Proline and TurboTorch tips. "B" size 9/16 in.-18 hose connections.



REG00439
R-LP Regulator
(0386-0705)

Brass regulator for use with MAPP®, Propane, and other LPG fuel gas. Adjustable to 60 psi. Fits standard POL valve and 9/16 in.-18 LH hose nut. Not for use with Acetylene. R-LP-993 Regulator for British 993 markets, Part No. 0386-0328

Propane and Mapp®

Hand Torches and Components Propane and Mapp® Gases



**TOL02011
STK-9 Kit (0386-0403)**

Components:

- STK-R Pressure regulator CGA-600
- ST-3 Tip
- Easy-to-change orifice
- Swivels 360°
- Instruction manual



**TOL02012
STK-99 Kit (0386-0851)**

Components:

- STK-R Pressure regulator CGA-600
- ST-33 Tip
- Easy-to-change orifice
- Swivels 360°
- Instruction manual

Propane and Mapp®

Propane and Mapp® Hand Torches / Tips



TIP00140
ST-33 Self-Igniting Tip Assembly Only
(0386-0850)
 • Fits existing STK-9 and STK-99 torches



TIP00138
ST-3 (0386-0171)

ServiceFirst Item No.	Mfg. No.	Copper Tubing Size Capacity with Mapp® Gas				Replacement Orifice No.
		Soft Solder		Silver Braze		
		in.	mm	in.	mm	
TIP00138	ST-3	3/8-2 1/2	10-60	1/4-1 3/8	6-35	STOR-3

Propane and Mapp®

Self-Lighting Torches and Kits Propane and Mapp® Gases



- TOL02013**
TL-44 TurboLite®
Self-Lighting Torch (0386-1273)
- TurboTorch swirl combustion technology gives you the best burn in a self-lighting package.
 - Flame tube swivels 180° for easy positioning.
 - MAPP® or Propane gas without changing the orifice.
 - Workplace-designed without exposed wires.
 - Trigger lock
 - Performance equivalent to T-3 LP tip.

- Features:**
- Replaceable tip-end
 - Easy to clean orifice
 - Heavy-duty piezo ignitor
 - Machined rotor
 - Wide lighting range

- Use with**
- CGA 600, 1 lb MAPP® or Propane tanks.
 Tank not included



KIT08337
TS-1B Kit (0386-0230)
 (Does not include gas)

Makes easy work of soldering in hard-to-reach places. Soft solders up to 2-1/2 in. (60 mm) and silver brazes up to 1-3/8 in. (35 mm). Can be used with MAPP® or Propane.

- Components:**
- ST-4 Tip
 - TSH Handle
 - TS-12, 12 ft (3.7 m) Hose assembly
 - STK-R Regulator, CGA-600
 - MT-1 MAPP® Tank
 - TSR Tank rack with retainer
 - Instruction manual



- TOL02004**
TP-10 Pencil Flame Propane Torch (0386-0860)
- Solid brass construction for lasting durability
 - Flame-control valve for precise heat adjustments
 - May be used with any 14.1 oz propane tank
 - Great for light application jobs:
 - Soldering
 - Thawing frozen pipes
 - Loosening rusty nuts and bolts
 - Heating
 - Light maintenance

Oxygen-Acetylene

Oxygen-Acetylene Cutting and Brazing Equipment



REG00441
221-05FP

ServiceFirst			High Pressure Gauge		Low Pressure Gauge		Delivery Range	
Item No.	Mfg. No.	Model No.	psig	kPa	psig	kPa	psig	kPa
REG00441	0386-0786	221-05FP Oxygen CGA-540	4000	28,000	100	700	4-80	28-570

Oxygen-Acetylene

Cutting and Brazing Equipment



**KIT08350
CWK-5 Kit (0386-0055)**

Components:

- 221-05FP Oxygen regulator CGA-540
- 201-05FP Acetylene regulator CGA-200
- 103-01FP Handle
- 2-W-J and 4-W-J Nozzle with mixer
- Reverse flow check valves
- 252-03P 3/16 in. x 12-1/2 ft Twin hose
- 251-01P Goggle
- 141-01 Carrying case and instruction booklet



**KIT08336
110-01FP Kit (0386-0038)**

Components:

- 221-05FP Oxygen regulator CGA-540
- 201-05FP Acetylene regulator CGA-200
- 101-01FP Handle with flash arrestors
- 151-01FP Cutting attachment
- 163-01P "B" to "A" Adapter
- 000-W-1, 0-W-1, and 2-W-1 Nozzles
- 0-3-101 Cutting tip
- 252-03P 3/16 in. A Size x 12-1/2 ft Twin hose
- 251-01P Goggles, L-1 striker and instruction booklet
- 141-01 Carrying case



**KIT09131
111-01FP Kit (0386-0039)**

Components:

- 221-05FP Oxygen regulator CGA-540
- 201-05FP Acetylene regulator CGA-200
- 101-01FP Handle with flash arrestors
- 151-01FP Cutting attachment
- 163-01P "B" to "A" Adapter
- 000-W-1, 0-W-1, and 2-W-1 Nozzles
- 0-3-101 Cutting tip
- 252-03P 3/16 in. A Size x 12-1/2 ft Twin hose
- 251-01P Goggles, L-1 striker and instruction booklet
- 160-01 Air/gas adapter
- A-5 Acetylene tip
- 141-01 Carrying case

Oxygen-Acetylene

Oxy/Acetylene Specialty Tips and Accessories



TOL02017
VMA-J-15 (0325-0109)
Multi-Flame Heating Nozzles
For heating, straightening, bending, brazing. Spiral mixer provides optimum flame characteristics.
For use with CWK Series handle.
Brazing capacity: 1/8 in. to 2-5/8 in.



TOL02016
VMA (0386-0544)
Multi-Flame Heating Tip
For maximum heating in a confined area.
Brazing capacity: 1/4 in. to 1-3/4 in.



ADP01029
VM-J (0386-0554)
Mixer-Adapters
For TurboTorch oxy-acetylene handles.
Fits CWK kit handle
No. 103-01FP (Forward valve)



TIP00152
VW-2



TIP00151
VW-1

Wrapper Tips
For complete distribution.
TIP00151
VW-1 (0386-0547)
Brazing capacity: 1/2 in. to 1 in.
TIP00152
VW-2 (0386-0548)
Brazing capacity: 5/8 in. to 1-1/8 in.

Regulators and Kits

Nitrogen Purging Equipment and Accessories



Purging Regulator (245-03P)

TurboTorch offers a nitrogen regulator with easy-to-read 2 in. (51 mm) gauges. Constructed of forged brass, designed for testing and purging brazed joints. This regulator is recommended by many air-conditioning code organizations for joint testing at commercial job sites.

ServiceFirst			H. P. Gauge		L. P. Gauge		Delivery Range	
Item No.	Mfg. No.	Model No.	psig	kPa	psig	kPa	psig	kPa
REG00442	0386-0813	245-02P Nitrogen CGA-580	4000	28,000	400	2800	0-250	0-1750
REG00434	0386-0814	245-03P Nitrogen CGA-580	4000	28,000	600	4200	0-500	0-3500

*Gauges scale = psig/kPa



TOL02021

TT-LP TurboTest Refrigerant Leak Detector (0386-0443)

The TurboTest "Total LP" Leak Detector fits standard TurboTorch MAPP® (MT-1) or Propane (PT-1) tanks. The TurboTest "Total LP" is compact, easy to use, and capable of detecting leaks of 8 oz per year. It's made of brass construction with a stainless-steel shield. Sniffer tube swivels 360° for easy handling. Heavy copper reactor plate (TT-R-LP) gives extra-long life, yet is easily replaceable. Rugged stainless-steel shroud will not rust. Easy-to-clean orifice is easily removed, reversed, and blown clean. Steady, uniform swirl combustion flame. Complete operating instructions are included.

TurboTotes®

Tank Carriers and Totes

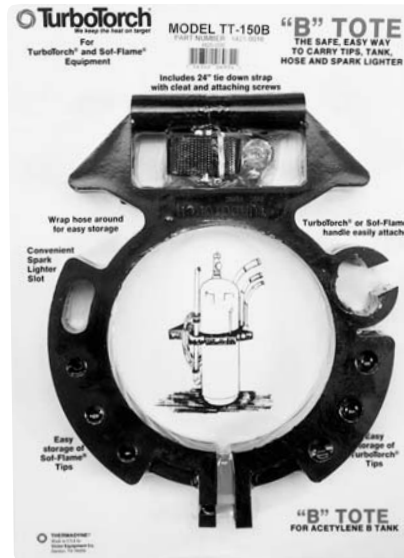

**TOL02005
TT-150 (1421-0016)**

Durable composite construction fits “B” tank. Features include a hose rack for storage while not in use and to help protect the regulator from accidental damage. A large handle keeps your tank portable. Your spark lighter is close at hand in its own holder accessory. “B” tote can be changed from one tank to another without special tools. A heavy nylon belt can keep your outfit secure on scaffolds or in the truck.



**TOL02006
TT-B (1421-0034)**

Heavy-duty steel construction fits “B” tank. Storage for tips, hose, handle, and striker.

Turbo Cylinders and Tanks



**TNK00876
PT-1 (0916-0004)**

- Propane replacement tank for use with all TurboTorch hand torches. Also for use with TurboTorch No. TT-LP leak detector.
- Contains 14.1 oz Propane.
- CGA 600 Connection
- Non-refillable



**TNK00877
MT-1 (0916-0009)**

- MAPP® Gas replacement tank for use with TurboTorch dual-fuel hand torches. Also use with TurboTorch No. TT-LP leak detector.
- Contains 16 oz of MAPP® gas.
- CGA 600 Connection
- Non-refillable



**CYL00201
AC-B (0916-0005)**

- Type "B" Acetylene cylinder, 40 cu ft capacity.
- CGA 520 Connection



**TNK00878
T-10PS-MT (0916-0029)**

- Tank with 10 lb capacity. Refillable with Propane.
- CGA 510 POL Connection
- 17-1/2 in. (44 cm) high
- 8 in. (20 cm) O.D.

Accessories



Acetylene Hose

ServiceFirst Item No.	Mfg. No.	Part Number	Description
HSE01407	0386-1090	AH-12	12 ft. Hose "A" Fitting
HSE01413	0386-1091	AH-24	24 ft. Hose "A" Fitting

"Total LP" Hose

ServiceFirst Item No.	Mfg. No.	Part Number	Description
HSE01414	H-12	1412-0080	12 ft. Hose "B" Fitting



TOL02007
L-1 Single Flint Striker (1423-0023)
 Cup type, round file

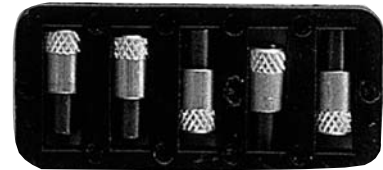

TOL02009
F-1 Flints for L-1 (1423-0024)
 Box of 5 flints



SHD00369

Model PL-812

Part No. (0386-0561)

- Durable fabric (8 in. x 12 in.)
 Roll it up and stuff it in your pocket.
- Reuseable
 Can be used 20, 50, 100 + Times. Will not burn or melt.
- Center-cut design
 Unique design makes it easier to use.
- Multi-Use
 Ideal for brazing, soldering, or welding.
- Safe to use
 No toxic smoke, made of non-asbestos, non-ceramic materials.

Plasma Cutting Systems



TOL02003
TPC-18
1/8 in. Cutting System (1445-0900)

Specifications

Output: 12 A fixed
 Input: 120 V (+/-10%)
 1 ph, 60 Hz, 20 A
 Cut Capacity: 1/8 in. (3.2 mm)
 Duty Cycle: 30%
 Panel Controls: On/off lighted
 Dimensions: Height: 10 in. (254 mm)
 Width: 9 in. (229 mm)
 Length: 16 in. (406 mm)
 Weight: 63 lb (25 kg)
 Gas: Air from built-in air compressor
 Pilot: Electrode to tip
 Control: Torch-mounted switch
 Lead Length: 20 ft (6.1 m)

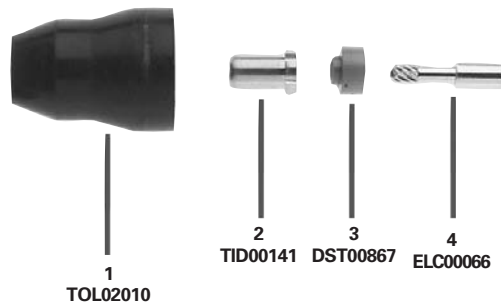

Torch Consumables Ordering Information

ServiceFirst Item No.	Mfg. No.	Part No.	Description
TOL02010	TSC-25	1445-0903	Shield Cup for TPC-18 and TPC-25 (1pk)
TID00141	T-Tip-18	1445-0909	Cutting tip for TPC-18 Only (5pk)
DST00867	TGD-25	1445-0905	Gas Distributor for TPC-18 and TPC-25 (1pk)
ELC00066	TE-25	1445-0904	Electrode for TPC-18 and TPC-25 (5pk)

Oxy/Fuel Kits, Cutting Welding and Brazing

Portable Oxy-Fuel Outfit



Features

- Brass handle
- Heavy-duty brass regulators
- Solid one-piece tip and mixer design
- Packaged for P.O.P.

Tote Combination Chart

ServiceFirst Item No.	Mfg. No.	Description
TOL02014	SKMC-1 (0426-0004)	TOTE w/o Cutting Attachment
TOL01997	SKMC-1T (0426-0005)	TOTE w/o CA w/tanks
TOL02015	SKMC-2 (0426-0006)	TOTE w/Cutting Attachment

Welding/Brazing Tip



Welding/Brazing Tip Chart

ServiceFirst Item No.	Part No.	Mfg. No.	Metal Thickness	Tip Size	Oxygen (psig)	Acetylene (psig)
TIP00153	0426-6009	SKW-1	3/64 in. - 3/32 in.	1	3/5	3/5
TIP00154	0426-6010	SKW-2	1/16 in. - 1/8 in.	2	3/5	3/5
TIP00155	0426-6011	SKW-3	1/8 in. - 3/16 in.	3	4/7	3/6

Hand Torches and Purging Kits

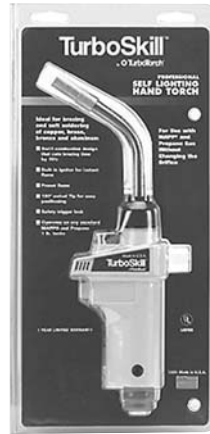

- TOL01999
SK-7000
Self-Lighting (Hand Torch)
(0426-4001)**
- Self-lighting
 - Preset flame
 - 180° swivel tip
 - Safety trigger lock
 - Operates on any standard Mapp® and Propane 1 lb tanks
 - U.L. listed
 - CGA 600 connection



- KIT08345
SKP-40T
Purging Kit
(0426-0009)**
- 40 cu ft nitrogen cylinder (0916-0028)
 - Durable 6 ft hose (1412-0145)
 - OSHA rated blow gun (0660-0105)
 - Regulator SKP-425 (0426-2001)
 - Carrying tote (1421-0059)



- REG00443
SKRP-425
Nitrogen Regulator
(0426-2001)**
- Designed for testing and purging brazed joints
 - Delivery range 0–425 psig
 - High visibility gauges
 - Constructed from forged brass
 - 1/4 in. flare outlet fitting
 - Smooth pressure adjustment

Cross Reference

Cross Reference – ServiceFirst Item No. to Manufacturer No.

ServiceFirst Item No.	Mfg No.	Page No.	ServiceFirst Item No.	Mfg No.	Page No.
ADP01029	VM-J (0386-0554)	17	TIP00135	T-2 (0386-0150)	10
CYL00201	AC-B (0916-0005)	20	TIP00136	T-3 (0386-0151)	10
DST00867	TGD-25 (1445-0905)	22	TIP00137	T-6 (0386-0154)	10
ELC00066	TE-25 (1445-0904)	22	TIP00138	ST-3 (0386-0171)	13
HDL00915	G-4 (0386-0308)	8	TIP00139	PL-4T (0386-0822)	11
HDL00916	H-4 (0386-0300)	11	TIP00140	ST-33 (0386-0850)	13
HSE01407	AH-12 (0386-1090)	21	TIP00142	A-3 (0386-0101)	6
HSE01413	AH-24 (0386-1091)	21	TIP00143	A-5 (0386-0102)	6
HSE01414	H-12 (1412-0080)	21	TIP00144	A-8 (0386-0103)	6
KIT08305	LP-1 Kit (0386-0247)	9	TIP00145	A-11 (0386-0104)	6
KIT08306	X-5B Kit (0386-0338)	4	TIP00146	A-14 (0386-105)	6
KIT08307	X-6MC Kit (0386-0339)	4	TIP00147	PL-3A (0386-0874)	7
KIT08308	PL-5ADLX-B Kit (0386-0833)	5	TIP00148	PL-5A (0386-0818)	7
KIT08309	PL-8ADLX-MC Kit (0386-0834)	5	TIP00149	PL-8A (0386-0819)	7
KIT08336	110-01FP Kit (0386-0038)	16	TIP00150	PL-12A (0386-0820)	7
KIT08337	TS-1B Kit (0386-0230)	14	TIP00151	VW-1 (0386-0547)	17
KIT08338	PL-5ADLX-MC Kit (0386-0832)	5	TIP00152	VW-2 (0386-0548)	17
KIT08339	PL-12ADLX-B Kit (0386-0836)	5	TIP00153	SKW-1 (0426-6009)	23
KIT08340	PL-4TDLX (0386-0838)	9	TIP00154	SKW-2 (0426-6010)	23
KIT08342	PLF-5A-DLX-B (0386-0865)	5	TIP00155	SKW-3 (0426-6011)	23
KIT08343	PLF-8A-DLX-MC (0386-0866)	5	TNK00876	PT-1 (0916-0004)	20
KIT08344	PLF-8A-DLX-B (0386-0867)	5	TNK00877	MT-1 (0916-0009)	20
KIT08345	SKP-40T (0426-0009)	24	TNK00878	T-10PS-MT (0916-0029)	20
KIT08348	X-3B Kit (0386-0335)	4	TOL01997	SKMC-1T (0426-0005)	23
KIT08349	X-4B Kit (0386-0336)	4	TOL01999	SK-7000 (0426-4001)	24
KIT08350	CWK-5 Kit (0386-0055)	16	TOL02003	TPC-18 (1445-0900)	22
KIT08351	PL-8ADLX-B Kit (0386-0835)	5	TOL02004	TP-10 (0386-0860)	14
KIT09131	111-01FP Kit (0386-0039)	16	TOL02005	TT-150 (1421-0016)	19
REG00433	AR-B (0386-0725)	8	TOL02006	TT-B (1421-0034)	19
REG00434	245-03P (0386-0814)	18	TOL02007	L-1 (1423-0023)	21
REG00439	R-LP (0386-0705)	11	TOL02009	F-1 (1423-0024)	21
REG00440	AR-MC (0386-0726)	8	TOL02010	TSC-25 (1445-0903)	22
REG00441	221-05FP (0386-0786)	15	TOL02011	STK-9 Kit (0386-0403)	12
REG00442	245-02P (0386-0813)	18	TOL02012	STK-99 Kit (0386-0851)	12
REG00443	SKRP-425 (0426-2001)	24	TOL02013	TL-44 (0386-1273)	14
SHD00369	PL-812 (0386-0561)	21	TOL02014	SKMC-1 (0426-0004)	23
TID00141	T-TIP-18 (1445-0909)	22	TOL02015	SKMC-2 (0426-0006)	23
TIP00131	A-2 (0386-0100)	6	TOL02016	VMA (0386-0544)	17
TIP00132	A-32 (0386-0106)	6	TOL02017	VMA-J-15 (0325-0109)	17
TIP00133	T-4 (0386-0152)	10	TOL02021	TT-LP (0386-0443)	18
TIP00134	T-5 (0386-0153)	10			

Cross Reference

Cross Reference – Manufacturer No. to ServiceFirst Item No.

Mfg No.	ServiceFirst Item No.	Page No.	Mfg No.	ServiceFirst Item No.	Page No.
110-01FP Kit (0386-0038)	KIT08336	16	SK-7000 (0426-4001)	TOL01999	24
111-01FP Kit (0386-0039)	KIT09131	16	SKMC-1 (0426-0004)	TOL02014	23
221-05FP (0386-0786)	REG00441	15	SKMC-1T (0426-0005)	TOL01997	23
245-02P (0386-0813)	REG00442	18	SKMC-2 (0426-0006)	TOL02015	23
245-03P (0386-0814)	REG00434	18	SKP-40T (0426-0009)	KIT08345	24
A-11 (0386-0104)	TIP00145	6	SKRP-425 (0426-2001)	REG00443	24
A-14 (0386-105)	TIP00146	6	SKW-1 (0426-6009)	TIP00153	23
A-2 (0386-0100)	TIP00131	6	SKW-2 (0426-6010)	TIP00154	23
A-3 (0386-0101)	TIP00142	6	SKW-3 (0426-6011)	TIP00155	23
A-32 (0386-0106)	TIP00132	6	ST-3 (0386-0171)	TIP00138	13
A-5 (0386-0102)	TIP00143	6	ST-33 (0386-0850)	TIP00140	13
A-8 (0386-0103)	TIP00144	6	STK-9 Kit (0386-0403)	TOL02011	12
AC-B (0916-0005)	CYL00201	20	STK-99 Kit (0386-0851)	TOL02012	12
AH-12 (0386-1090)	HSE01407	21	T-10PS-MT (0916-0029)	TNK00878	20
AH-24 (0386-1091)	HSE01413	21	T-2 (0386-0150)	TIP00135	10
AR-B (0386-0725)	REG00433	8	T-3 (0386-0151)	TIP00136	10
AR-MC (0386-0726)	REG00440	8	T-4 (0386-0152)	TIP00133	10
CWK-5 Kit (0386-0055)	KIT08350	16	T-5 (0386-0153)	TIP00134	10
F-1 (1423-0024)	TOL02009	21	T-6 (0386-0154)	TIP00137	10
G-4 (0386-0308)	HDL00915	8	TE-25 (1445-0904)	ELC00066	22
H-12 (1412-0080)	HSE01414	21	TGD-25 (1445-0905)	DST00867	22
H-4 (0386-0300)	HDL00916	11	TL-44 (0386-1273)	TOL02013	14
L-1 (1423-0023)	TOL02007	21	TP-10 (0386-0860)	TOL02004	14
LP-1 Kit (0386-0247)	KIT08305	9	TPC-18 (1445-0900)	TOL02003	22
MT-1 (0916-0009)	TNK00877	20	TS-1B Kit (0386-0230)	KIT08337	14
PL-12A (0386-0820)	TIP00150	7	TSC-25 (1445-0903)	TOL02010	22
PL-12ADLX-B Kit (0386-0836)	KIT08339	5	TT-150 (1421-0016)	TOL02005	19
PL-3A (0386-0874)	TIP00147	7	TT-B (1421-0034)	TOL02006	19
PL-4T (0386-0822)	TIP00139	11	T-TIP-18 (1445-0909)	TID00141	22
PL-4TDLX (0386-0838)	KIT08340	9	TT-LP (0386-0443)	TOL02021	18
PL-5A (0386-0818)	TIP00148	7	VMA (0386-0544)	TOL02016	17
PL-5ADLX-B Kit (0386-0833)	KIT08308	5	VMA-J-15 (0325-0109)	TOL02017	17
PL-5ADLX-MC Kit (0386-0832)	KIT08338	5	VM-J (0386-0554)	ADP01029	17
PL-812 (0386-0561)	SHD00369	21	VW-1 (0386-0547)	TIP00151	17
PL-8A (0386-0819)	TIP00149	7	VW-2 (0386-0548)	TIP00152	17
PL-8ADLX-B Kit (0386-0835)	KIT08351	5	X-3B Kit (0386-0335)	KIT08348	4
PL-8ADLX-MC Kit (0386-0834)	KIT08309	5	X-4B Kit (0386-0336)	KIT08349	4
PLF-5A-DLX-B (0386-0865)	KIT08342	5	X-5B Kit (0386-0338)	KIT08306	4
PLF-8A-DLX-B (0386-0867)	KIT08344	5	X-6MC Kit (0386-0339)	KIT08307	4
PLF-8A-DLX-MC (0386-0866)	KIT08343	5			
PT-1 (0916-0004)	TNK00876	20			
R-LP (0386-0705)	REG00439	11			



Literature Order Number	RSP-PRC023-EN
Filing Hierarchy	Tool and Test Equipment/Welding and Brazing Products
Date	June 2003
Supersedes	New
Stocking Location	Inland

Trane has a policy of continuous product and product data improvement and reserves the right to change design and specifications without notice.