

Pipe and cable fastening with plastic pipe clamps

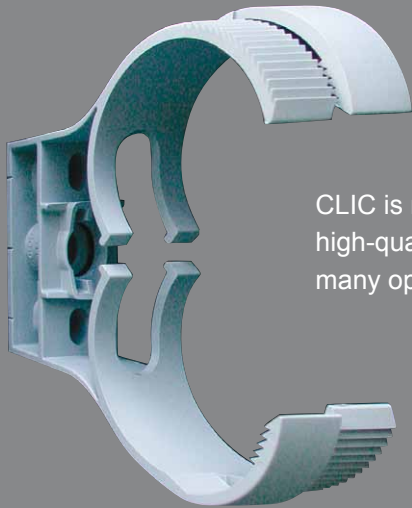

Gripping possibilities for the world of pipe and cable fastening



CLIC is more than just a plastic clamp: CLIC offers a high-quality system of solutions allowing you to grip many opportunities.

A product of Egli, Fischer & Co. Ltd., Zurich, www.clic-original.com
manufactured by BIRO, www.biro.ch

clic[®]

Trade mark rights

Patents: The CLIC technology is protected by Swiss and international patents held by Egli, Fischer & Co. Ltd., Zurich (EF).

Trademarks: All product and brand names mentioned in this publication are trademarks or registered trademarks of EF or of the respective owner. CLIC, DELTA and TILCA in particular are internationally registered EF trademarks.

Illustrations: Illustrations are owned by EF or reproduced by kind courtesy of their owners.

Copyright: All rights reserved. Digital reproduction, even partially, only upon written approval by EF.

www.clic-original.com

Index

CLIC – the original	4
References	5
CLIC 8 to 64 mm – Technology	6
CLIC 8 to 64 mm – System	7
CLIC 63 to 127 mm – Technology	8
CLIC 63 to 127 mm – System	9
Quality	10
How to find the right CLIC	11



CLIC – the original

Since 1975 the self-locking pipe clamp CLIC has proved itself millions of times. Cables and pipes fixed with «Swiss Quality» are fast and securely fixed throughout the world.

Today, system solutions (pipe clamps, screws, plugs and accessories) are required, for instance in telecommunications. Consulting during the phase of planning, becomes more and more important. A long experience in business and our internal development division have allowed many individual solutions in collaboration with our customers engineers. Our production is able to preassemble tailor-made CLIC systems even at short notice.

The proven solution for cable conduits

Easy handling and fast mounting predestinates CLIC for fixing cable conduits.

The smart solution for specific tasks

For installations with higher demands, public areas or infrastructural buildings, the qualities of CLIC and CLIC TOP are especially recommended because of the high mechanical capacity, the excellent impact resistance and temperature stability.

The best solution for highest demands

CLIC TOP ideally covers the increasing demands for fixing points in sensitive environments. In many tunnels coaxial cables for radio and mobile telephone systems are openly mounted. The performance may not be impaired by interference from metallic parts. The plastic pipe clamp CLIC TOP is therefore the best solution for the installation.

Application areas

- Electrical installations
- Sanitary installations
- Control technique
- Chemical industry, difficult environments
- Clean rooms
- Radiating cables
- Fire alarm systems
- Swimming pools
- Central vacuum cleaners

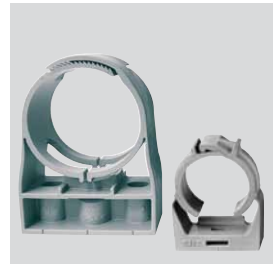

clictop

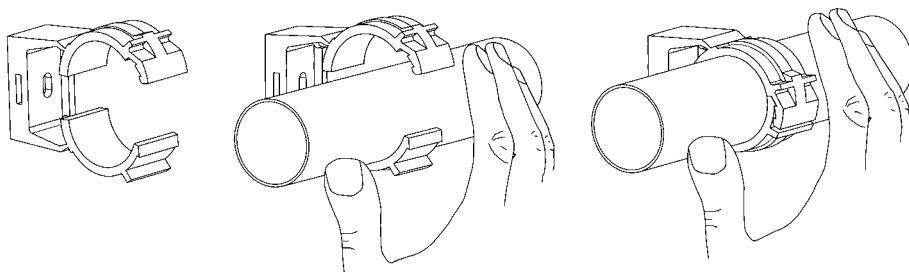

Single-hand installation – a matter of course with CLIC: place the pipe, apply slight pressure and the clamp locks itself with a sharp *clic*.

Saves up to 40% installation time in comparison to commonly used clamps.

References

Approved under hardest conditions

Egli Fischer exports to more than 40 countries. The «Swiss Quality» product CLIC convinces wherever special requirements emerge.

Characteristics such as non-corroding material, safety – also in case of fire – and easy installation let the CLIC become the favorite in tunnel construction, as well as for outside areas with chemical and weather ascendancies. Further reference applications are installations in nuclear power plants (electrical pipes) and in waste incineration facilities (waste outfall, heating and heat recovery).

High-speed tunneling

With a route length of 57 km the Gotthard Base Tunnel in Switzerland is the world's longest rail tunnel. Multiple CLIC solutions for mounting cables and tubes provide a state of the art installation guaranteeing safety and durability in the different tunnels, shafts and passages representing a total length of 151.84 km. When completed, passenger high speed trains and freight trains of up to 4000 t will travel through the new tunnels.

Since 2002 tilting trains *ICE3* are speeding with up to 250 km/h through the 30 tunnels of the Cologne–Rhine/Main railway line. Upon the total length of 47 km, coaxial cables are mounted with about 45,000 CLIC TOP clamps. The system for high-quality fixing points includes also various types of screws in stainless steel (A4).

CLIC clamps were also used in other railway tunnels as well as in the underground in Hannover, Vienna, Hong Kong, Singapore, Istanbul, London, Los Angeles and other cosmopolitan cities.

Coaxial cables in road tunnels

One of the first CLIC applications has proved itself successfully in the *Schöneich* road tunnel (Switzerland), where radiating coaxial cables for radio and mobile phone communication were openly mounted at a wall distance of 40 mm. At the renovation of the tunnel in 2001, the cables had to be replaced by new ones with better electrical characteristics. The roughly 4000 CLIC clamps could still be opened easily – even after about 20 years of exposure to temperature distinctions, humidity and exhaust gases – and have been replaced by new CLICs.

Corrosion-resistant and fire-proof – ideal for shipping

On the *European Vision*, built by the Alstom Atlantique shipyard in Saint Nazaire (F), CLIC was used for all water and compressed air pipes. Warm, cold, cooling and drinking water flow in copper pipes that are fixed with CLIC. Resistance against seawater and the good characteristics relating to fire were – after Alstom's own testing – the deciding factors for CLIC TOP. Alstom has used CLIC TOP also for other passenger liners, including the *Queen Mary II*.



Bundled pipes and cables with one CLIC clamp at the underside of the *Ponte Val Calanca* bridge in Switzerland.



CLIC is often used for cable fixing in railway- and underground tunnels.



CLIC has proved itself in numerous road tunnels such as the *Gotthard* tunnel in Switzerland.



Since CLIC TOP is unimpaired by saltwater, it is preferentially used by shipbuilders.

CLIC 8 to 64 mm – Technology

The advantages of the original

Secure, fast, economical, user-friendly – a true fact. The outstanding features of CLIC are self-explanatory. Benefit from the advantages and the safety of the original that has proved itself since 1975.

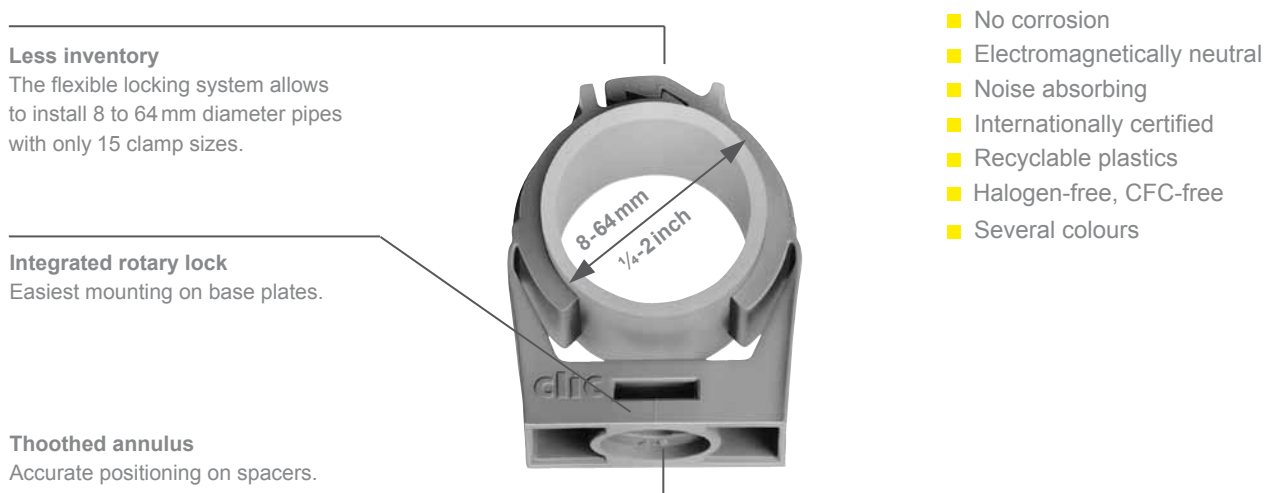
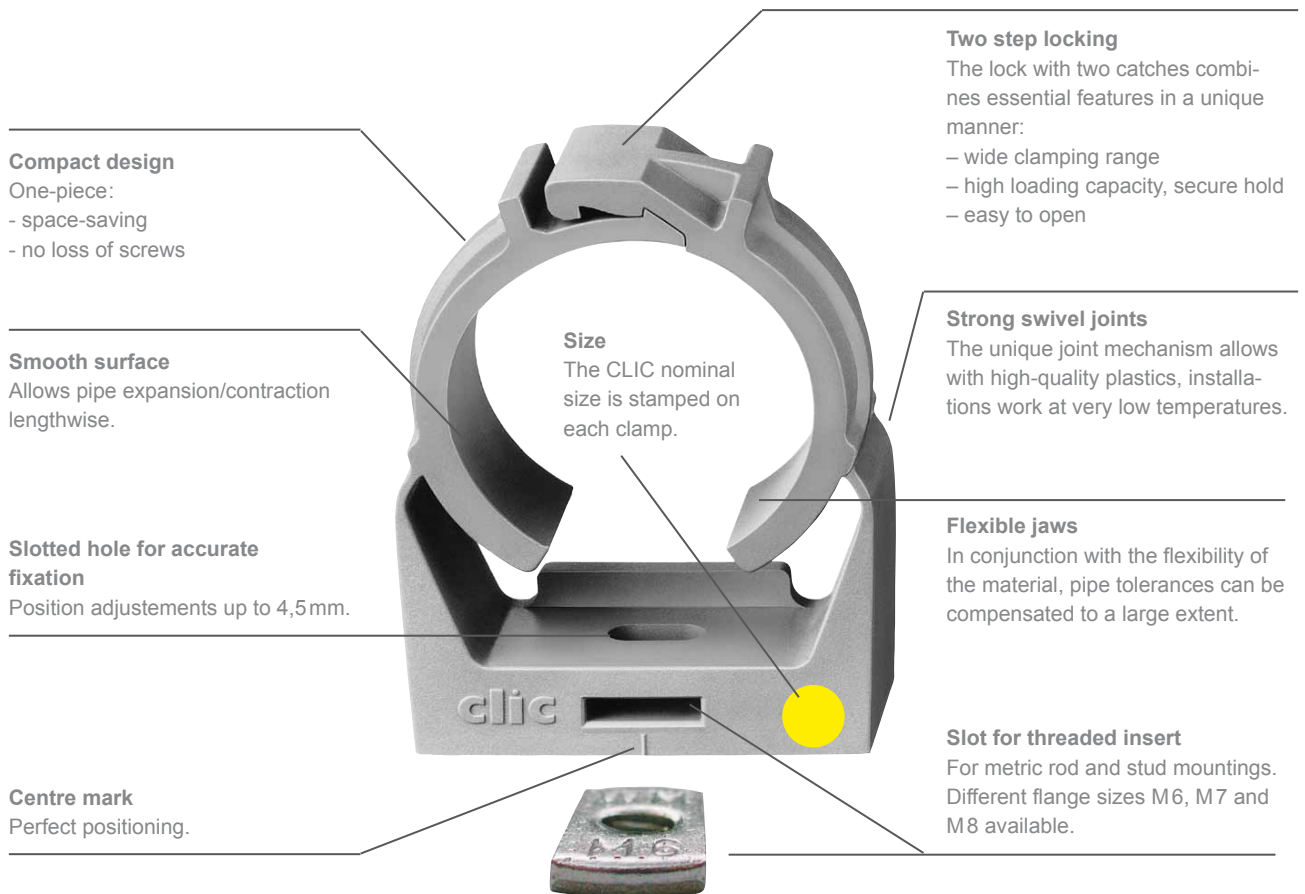

CLIC 8 to 64 mm – System

Mounting with system

CLIC is more than just a pipe clamp: CLIC is a comprehensive mounting system with perfectly matching parts that can be used separately or combined into customized pre-assembled sets.

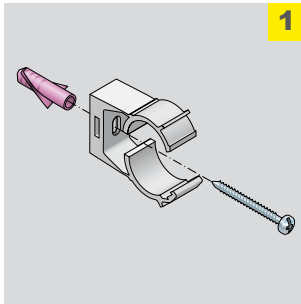

1

Installation with wood screw and DELTA nylon plug.

Surfaces:
Masonry, Concrete

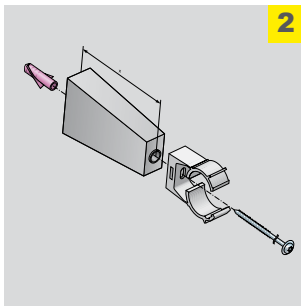

2

Installation with CLIC spacer, round-head wood screw with pressed-on washer and DELTA nylon plug.

Surfaces:
Masonry, Concrete

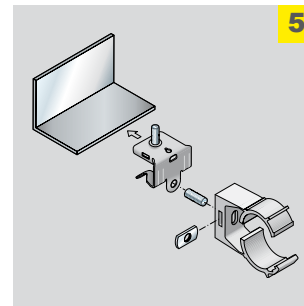

5

Installation with CLIC hammer on spring steel clamp, CLIC flange and a threaded stud M6

Surface:
Steel beam

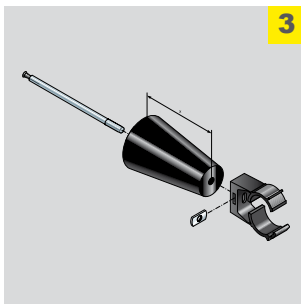

3

Installation with CLIC round spacer, TILCA fire-resisting anchor M6 and CLIC flange. Stainless steel 1.4529 on demand.

Surface:
Concrete



6

Installation of two CLIC onto base plate fixed with TILCA nail-in plug.

Surfaces:
Masonry, Concrete

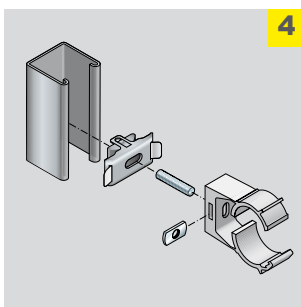

4

Installation with CLIC SLICK strut nut M6, CLIC flange and a threaded stud M6.

Surface:
Strut 41 × 41 and
41 × 21 mm

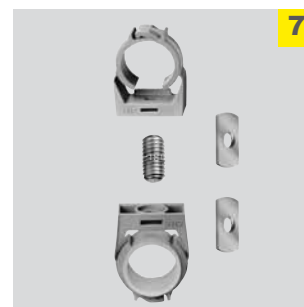

7

Installation CLIC to CLIC with threaded stud and two CLIC flanges.

CLIC 63 to 127 mm – Technology

Perfect for large pipes

For large diameters CLIC also offers the perfect solution with high-quality plastic materials. Count on the advantages and quality of the original that proves itself world-wide successfully, even under very hard conditions, for more than 25 years.

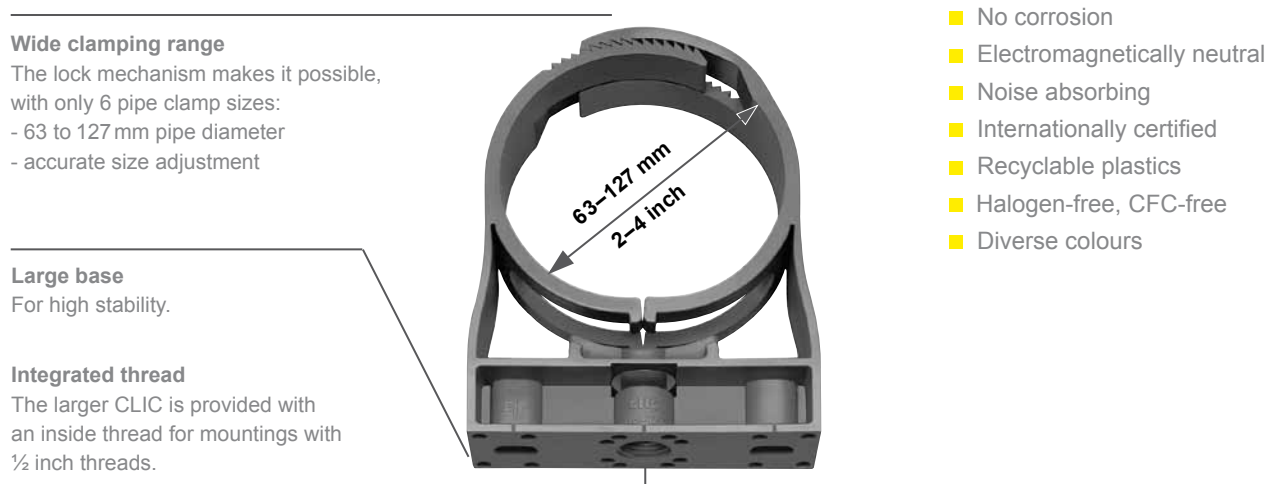
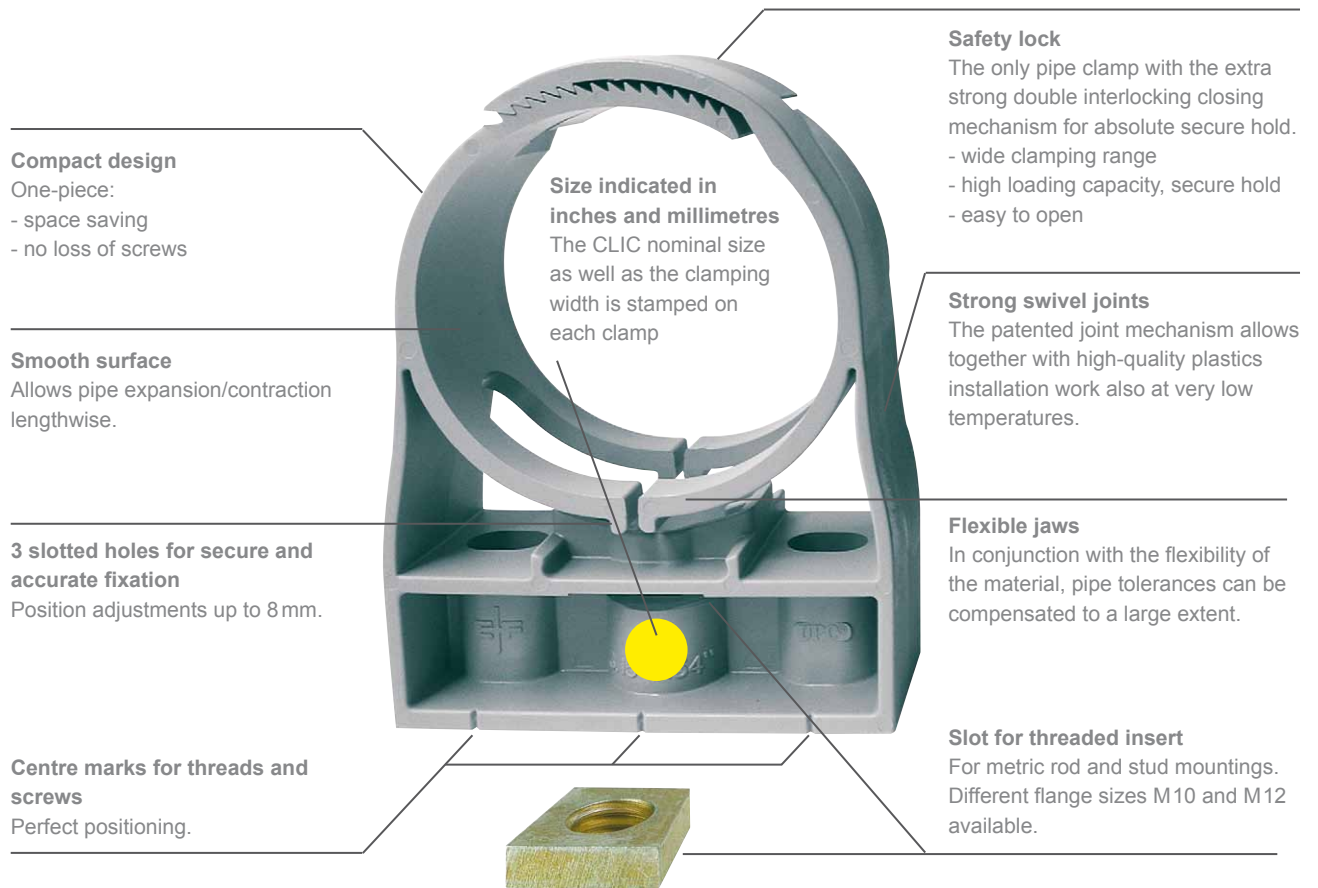

CLIC 63 to 127 mm – System

Mounting with system

The vast range of CLIC accessories allow various mounting possibilities. Combine your own assembly or ask our experts. If requested we tailor customer or project specific pre-assembled sets. This guarantees the optimal loading capacity and efficient mounting.

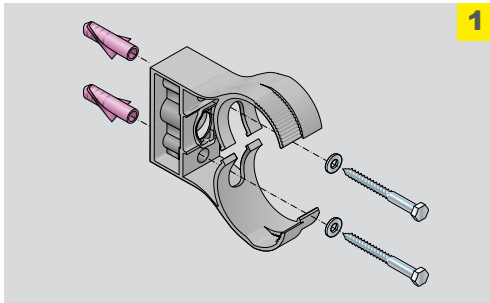

1

Installations with two hex cap wood screws and two DELTA nylon plugs.

Surfaces:
Masonry, Concrete

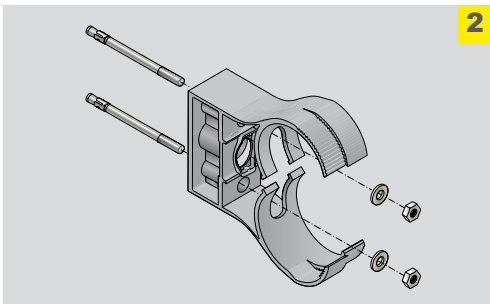

2

Installation with two TILCA anchor bolts M8. Stainless steel 1.4529 on demand.

Surface:
Concrete

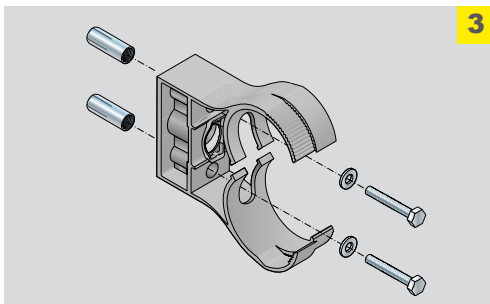

3

Installation with two TILCA flush anchors M8, two washers and two hex cap metal screws M6.

Surface:
Concrete

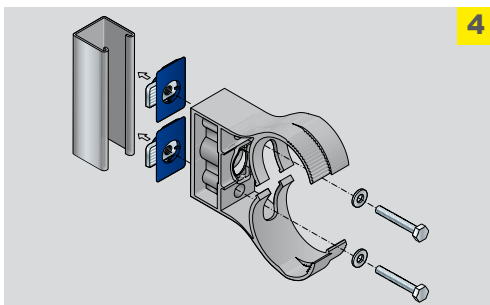

4

Installation with two CLIC thread supports, two washers and two hex cap metal screws M6.

Surface:
Strut 41×41 and
41×21 mm

Quality

The widest choice

For most CLIC products you have the option between the two material qualities CLIC and CLIC TOP. Numerous certifications give you the additional assurance of having made the right choice.



clíc

The proven solution

High-quality copolymer

UV stabilized

Good chemical resistance

Weatherproof

Working temperature
-25 up to +90 °C long-term

Hinges allow installation
down to -10 °C

clíc^{top}

For highest demands

Pure polyamide

UV resistant

Excellent chemical resistance

Chloride salt and termite
resistant

Working temperature
-40 up to +110 °C long-term

Hinges allow installation
down to -25 °C

High low-temperature impact
strength

High flexibility at low and high
temperatures



Certifications

Nearly all sizes of both qualities, CLIC and CLIC TOP, are certified by KIWA® and UL®. For details please see table on page 11.



How to find the right CLIC

The most important criteria for selection, such as type and diameter of the pipe as well as existing certifications, are listed together in table form, allowing you to find quickly the right CLIC.

Sizes in function of pipe and cable types

CLIC ¹	Steel		Copper	Cast iron	PE	PVC	Cable ducts	Coaxial cable
	mm	inch	mm	mm	mm	mm	metric measures	inch
8	7,8-9,5						8	
10	9,5-11,8		10				10	
12	11,8-14,3	13,5	12				12	
15	14,3-16,8		15			16	16	1/2
17	16,8-19,5	17,2	18					
20	19,5-21,8	21,3				20	20	5/8
22	21,8-24,8		22					
25	24,8-27,8	26,9				25	25	
28	27,8-31,2		28					7/8
32	31,2-35,5	33,7	35		32	32	32	
36	35,5-39,5							1 1/4
40	39,5-43,5	42,4	42		40		40	
47	46,5-50,5	48,3		48	50	50	50	1 5/8
51	50,5-55,5		54					
59	58,5-64,0	60,3	64			63		
63	63-71				63		63	
71	71-80	76,1	76	78	75	75		
80	80-90	88,9	89					
90	90-101				90			
101	101-113		108	110	110	110		
113	113-127	114,3	114		125	125		

¹Clamp size/Clamping range mm

Certifications/recommended loading capacity

CLIC Clamp Size	KIWA®		UL®		Recomm. load ¹ N
	CLIC	CLIC TOP	CLIC	CLIC TOP	
8	■	■	■	■	170
10	■	■	■	■	185
12	■	■	■	■	200
15	■	■	■	■	220
17	■	■	■	■	235
20	■	■	■	■	250
22	■	■	■	■	270
25	■	■	■	■	300
28	■	■	■	■	320
32	■	■	■	■	370
36	■	■	■	■	400
40	■	■	■	■	440
47	■	■	■	■	470
51	■	■	■	■	500
59			■	■	540
63			■	■	600
71			■	■	740
80			■	■	880
90			■	■	1000
101			■	■	1200
113			■	■	1350

¹Safety factor ≈ 3 included for hanging mounting at 20 °C

Our expertise: Your security.

www.clic-original.com