

# Refrigeration Condenser Fan 5.0 and 5.6" Diameter Open Dripproof, Totally Enclosed Air Over and Open Air Over

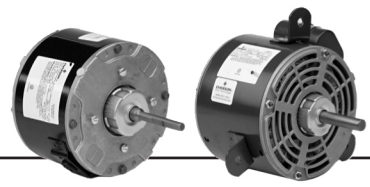

## APPLICATIONS:

Condenser cooling fan motors to meet manufacturer's requirements for commercial refrigeration units.

## FEATURES:

- OEM Direct Replacements
- Single Speed
- Automatic Reset Thermal Overload Protector
- Designed for use with 370V Capacitors
- **Discount Symbol: DS-3HAC**

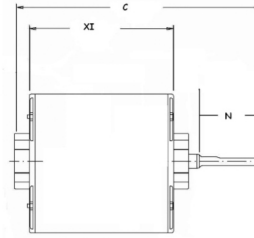

Figure A

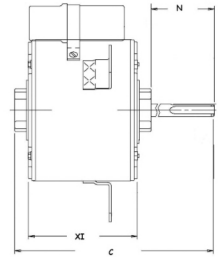

Figure B

## 5.0" Diameter, 3/8" Diameter Shaft

HP	RPM	Volts	Catalog Number	List Price	Bearings	Cap. MFD	Amps	Shaft N	Shell XI	Total C	Mount	Ship Wgt.	Notes	OEM
1/20	1500	230	1775	\$178	Slv	-	1.1	2.5	3.3	6.9	Hub Ring	7	98	TE
1/15	1500	230	1779	\$178	Slv	-	1.9	2.5	3.5	7.2	Hub Ring	8	98	TE

## 5.6" Permanent Split Capacitor

HP	RPM	Volts	Catalog Number	List Price	Bearings	Cap. MFD	Amps	Shaft N	Shell XI	Total C	Mount	Ship Wgt.	Notes	OEM
1/6	1550	208-230	6128	\$263	Slv	3.0	1.1	2.3	3.6	7.2	Resilient	17	64, H36	CO
	1550	208-230	1645	\$263	Ball	3.0	1.4	2.1	3.8	6.4	Stud	12	H35	HU
1/5	1075	208-230	1648	\$244	Ball	4.0	2.0	2.5	4.3	7.8	Stud	13	H35	HU
1/4	1550	230	6124	\$242	Slv	5.0	2.1	3.0	4.1	7.1	Band	13	64, H36	CO
	1625	208-230	6129	\$273	Slv	5.0	1.5	2.3	4.3	7.6	Resilient	17	64, H36	CO
	1625	230	3042	\$239	Ball	4.0	1.4	1.5	5.1	7.7	Hub Ring	12	64, H4, H36	TY
	1625	230	8330	\$241	Slv	4.0	1.9	2.2	4.3	7.7	3 Lugs	12	64, 98, H36, H42	TE
	1625	380-420/460	8331	\$257	Slv	4.0	.95	2.2	4.3	7.7	3 Lugs	12	98, 64, H36, H42	TE
1/3	1625	230	6127	\$264	Slv	4.0	2.4	1.75	5.8	8.7	Resilient	17	64, H45	CO
	1625	208-230	7232	\$268	Slv	6.0	2.9	3.7	4.6	9.63	Hub Ring	16	64, H35	HR
1/2	1725	208-230	644	\$250	Ball	5.0	2.7	3.5	5.1	8.6	Stud	15	H18, H36	HU

CO = Copeland

HU = Hussman

HR = Hill Refrigeration

TE = Tecumseh

TY = Tyler

Note 64 Capacitor Included  
 Note 98 50/60 Hz  
 Note H4 2-1/4" hub rings  
 Note H18 Conduit box

Note H35 Open Air Over  
 Note H36 Open Dripproof  
 Note H42 Shaft Down  
 Note H45 Totally Enclosed Air Over

† All marks shown within this document are properties of their respective owners