

Straight



Features:

- Maximum working pressure (PS) with the flow in the direction of the arrow on the body: 700 psig, 48 bar
- Maximum working pressure (PS) with the flow against the direction of the arrow on the body: 300 psig, 24 bar
- Working temperature range (TS): -40°F/300°F, -40°C/149°C
- Compatible with all CFC, HCFC and HFC refrigerants and oils
- UL/cUL Listed, CE Certified
- Forged brass body with full size openings for maximum flow and minimum pressure drop
- Fitted with two stainless steel diaphragms and one phosphor bronze diaphragm for positive isolation
- Thermally stable hand wheel for operation in wide temperature ranges

Flare to Flare

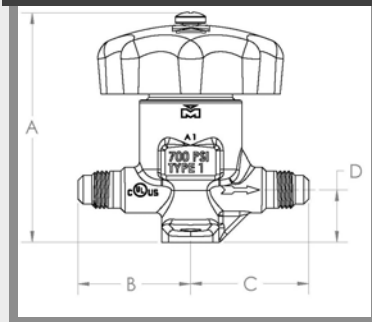

Part Number	Size	A Open		B		C		D		Wt	
		in	mm	in	mm	in	mm	in	mm	lb	kg
A 14833	1/4	2.70	69	1.32	34	1.38	35	0.62	16	0.59	0.27
A 14835	3/8	2.70	69	1.36	35	1.42	36	0.62	16	0.60	0.27
A 14836	1/2	3.46	88	1.62	41	1.86	47	0.84	21	1.03	0.47
A 14837	5/8	3.46	88	1.70	43	1.93	49	0.84	21	1.05	0.48

Solder to Solder

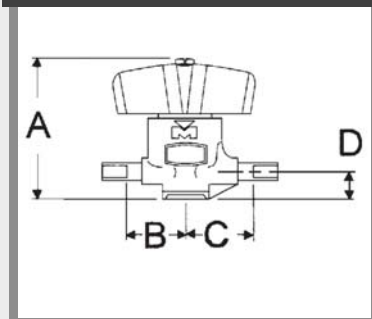

Part Number	Size	A Open		B		C		D		Wt		
		in	mm	in	mm	in	mm	in	mm	lb	kg	
A 14838	1/4	6	2.70	69	1.04	26	1.10	28	0.62	16	0.85	0.38
A 14840	3/8	10	2.70	69	1.04	26	1.10	28	0.62	16	0.57	0.26
A 14841	1/2	13	3.49	89	1.32	34	1.56	40	0.84	21	0.97	0.44
A 14842	5/8	16	3.49	89	1.20	30	1.44	37	0.84	21	1.00	0.45

Solder to Solder Ext Ends

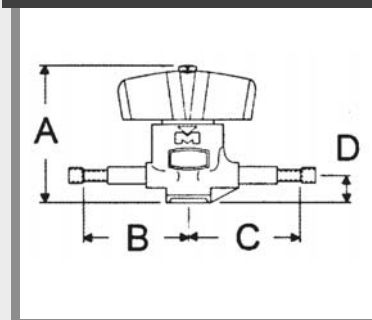

Part Number	Size	A Open		B		C		D		Wt		
		in	mm	in	mm	in	mm	in	mm	lb	kg	
A 14848	1/4	6	2.70	69	2.66	68	2.72	69	0.62	16	0.86	0.39
A 14850C	3/8	10	2.70	69	2.82	72	2.88	73	0.62	16	0.62	0.28
A 14851	1/2	13	3.49	89	3.04	77	3.28	83	0.84	21	1.06	0.48
A 14852	5/8	16	3.49	89	3.11	79	3.35	85	0.84	21	1.17	0.53