

CHECK VALVES

MUELLER CHECK VALVES

TECHNICAL DATA

- Available in 1/4" through 5/8" flare sizes and 1/4" thru 7/8" solder sizes.
- Recognized under the component program of Underwriters Laboratories for use in the USA and Canada.
- Maximum working pressure is 500 PSIG.
- Maximum temperature rating at +200° F.

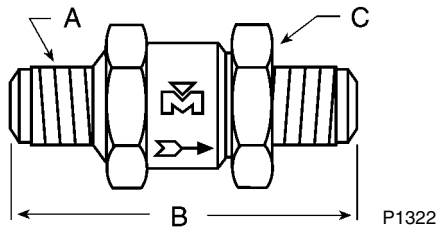

Flare to Flare

PART NO.	SIZE	B	C	WT/EA.
	Flare A			
A-15620	1/4	2-3/16	13/16 Hex	.14
A-15621	3/8	2-13/32	13/16 Hex	.18
A-15622	1/2	3	1-1/4 Oct	.44
A-15623	5/8	3-3/16	1-1/4 Oct	.52

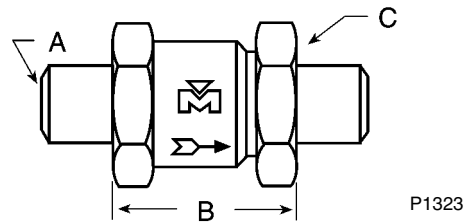

Solder to Solder

Shipped loosely assembled.

PART NO.	SIZE	B	C	WT/EA.
	O.D. A			
A-15628	1/4	1-3/16	13/16 Hex	.13
A-15629	3/8	1-5/32	13/16 Hex	.13
A-15630	1/2	1-7/16	1-1/4 Oct	.36
A-15631	5/8	1-7/16	1-1/4 Oct	.37

* Teflon Seat Disc.

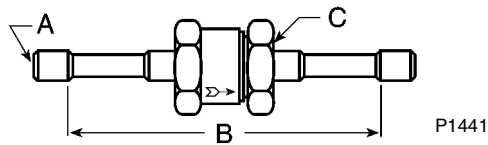

Solder to Solder - Extended Ends

PART NO.	SIZE	B	C	WT/EA.
	O.D. A			
A-15632	1/4	4-7/16	13/16 Hex	.17
A-15633	3/8	4-9/16	13/16 Hex	.17
A-15634	1/2	4-29/32	1-1/4 Oct	.42
A-15635	5/8	5-13/64	1-1/4 Oct	.48

CHECK VALVES

MUELLER FOUR-BOLT CHECK VALVES

Specifications

Technical Data	
Refrigerants	All fluorinated types
Maximum Working Pressure	500 psig
Burst Pressure	2500 psig
Working Temperature Range	-40° F/300° F
Pressure Required to Open	B-34235 <1 psi
	B-34236 <1 psi
	B-34237 2 psi
	B-34238 2 psi
	B-34239 2 psi
	B-34240 2 psi
Recommended Bolt Torques	B-34235 8-15 ft-lb
	B-34236 8-15 ft-lb
	B-34237 10-20 ft-lb
	B-34238 10-20 ft-lb
	B-34239 10-20 ft-lb
	B-34240 15-25 ft-lb
	B-34241 15-25 ft-lb

NOTE: Not to be installed with the bonnet facing down.

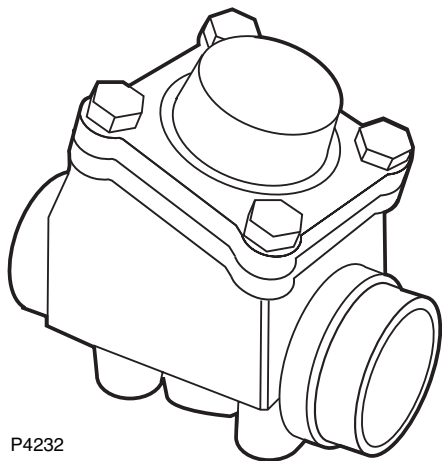

P4232

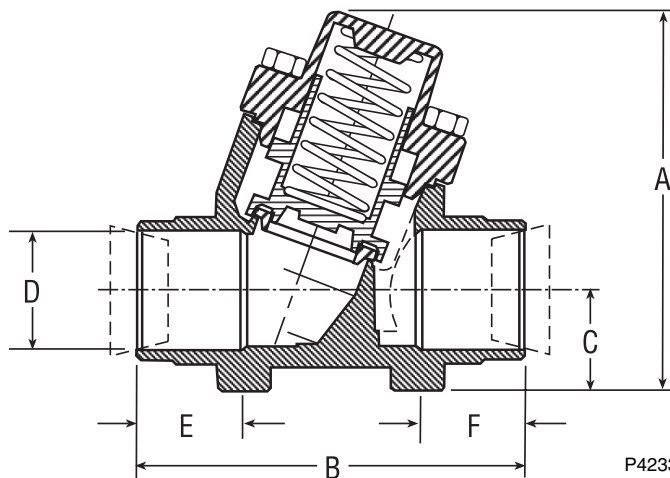

P4233

FOUR-BOLT CHECK VALVES

Part No.	Size	A	B	C	D	E	C _v	Weight
B-34235	7/8	3-19/32	3-11/16	31/32	7/8	15/16	5.05	2.46
B-34236	1-1/8	3-19/32	3-11/16	31/32	1-1/8	1	6.70	2.31
B-34237	1-3/8	4-9/16	4-3/4	1-5/16	1-3/8	1-1/16	8.71	5.42
B-34238	1-5/8	4-9/16	4-3/4	1-5/16	1-5/8	1-1/16	10.06	5.04
B-34239	2-1/8	5-7/8	6-3/8	1-11/16	2-1/8	1-1/2	36	12.6
B-34240	2-5/8	8	8-7/8	2	2-5/8	1-7/8	70	
B-34241	3-1/8	8	8-7/8	2	3-1/8	1-7/8	*	

*Consult Factory.

VALVES

MUELLER BALL VALVES

Specifications

Technical Data	
Refrigerants	HFC, CFC, HCFC
Maximum Working Pressure	700 psig
Working Temperature Range	-40° F/300° F

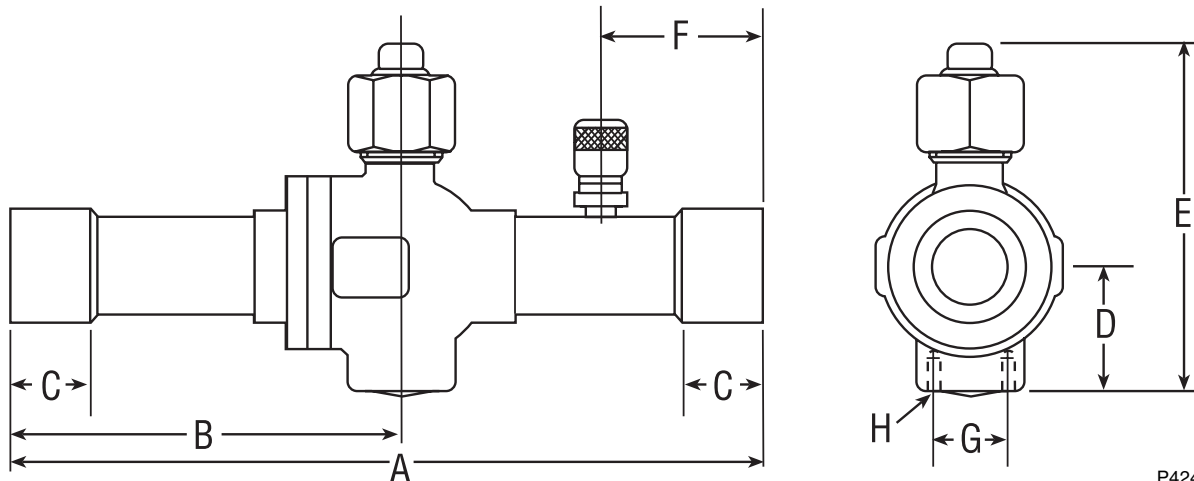

P4246

Straight Thru Ball Valve

PART NO.	SIZE	A (in.)	B (in.)	C (in.)	D (in.)	E (in.)	F** (in.)	G** (mm)	H**	SEAL CAP KIT****
A 17859	1/4	5-7/16	2-15/16	5/16	7/8	2-3/4	NA	14	M4 x .07	A 17842
A 17860	3/8	5-1/2	3	5/16	7/8	2-3/4	15/16	14	M4 x .07	A 17842
A 17861	1/2	6-3/8	3-7/16	3/8	7/8	2-3/4	1-3/16	14	M4 x .07	A 17842
A 17862	5/8	6-3/8	3-7/16	1/2	7/8	2-3/4	1-3/8	14	M4 x .07	A 17842
A 17863	3/4	7-7/16	3-7/8	5/8	1-1/4	3-1/2	1-1/2	20	M4 x .07	A 17843
A 17864	7/8	7-7/16	3-7/8	3/4	1-1/4	3-1/2	1-5/8	20	M4 x .07	A 17843
A 17865	1-1/8	8-7/16	4-5/16	7/8	1-9/16	3-13/16	1-3/4	25	M4 x .07	A 17844
A 17866	1-3/8	10	5	1	1-1/2	4-3/16	2-1/16	30	M6 x 1.0	A 17844
A 17867	1-5/8	11	5-1/2	1-1/8	1-11/16	4-7/8	2-1/4	34	M6 x 1.0	A 17845
A 17868	2-1/8	12	6	1-3/8	2-1/8	5-9/16	2-7/16	34	M6 x 1.0	A 17845
A 17869	2-5/8	13-1/2	6-13/16	1-1/2	***	***	***	34	M6 x 1.0	A 17846
A 17870	3-1/8	16	8	1-3/8	3	7-3/8	3-1/8	34	M6 x 1.0	A 17846
A 17871*	2-5/8	12	6	1-3/8	2-1/8	5-5/8	2-3/8	34	M6 x 1.0	A 17845
A 17872*	3-1/8	12	6	1-11/16	2-1/8	5-5/8	3-1/16	34	M6 x 1.0	A 17845

*Reduced port.

**Where applicable.

***Consult factory for details.

****Seal Cap Kit includes seal cap, seal cap gasket, anti-friction ring, cap nut.

Prefixed for Ball Valve Options:

- A = Standard
- AC = Standard with access
- AP = Drilled & tapped
- AQ = Drilled & tapped with access

Examples:

A 17860, 3/8" without access

AC 17860, 3/8" with access

VALVES

MUELLER BALL VALVES (cont)

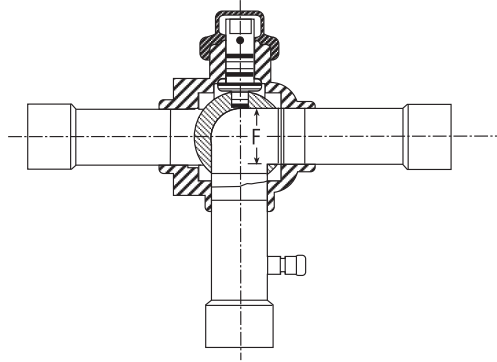

P4245

Mueller 3-Way Ball Valves with Access Ports

PART NO.	SIZE	A	B	C	D	E	F	G	WEIGHT
AU17860	3/8	4-7/8	2-21/32	2-19/64	3-21/32	5/16	1/2	41/64	.67
AU17861	1/2	5-3/8	3-3/64	2-43/64	4-7/32	3/8	1/2	53/64	.70
AU17862	5/8	5-3/8	2-59/64	2-35/64	4-7/64	1/2	1/2	27/32	.70
AU17863	3/4	6-1/4	3-57/64	3	5-1/4	5/8	3/4	55/64	NA
AU17864	7/8	5-31/32	3-5/32	2-29/32	4-7/8	3/4	3/4	27/32	1.44
AU17865	1-1/8	6-39/64	3-3/16	3-7/64	5-31/64	29/32	1	53/64	2.76
A17545	1-3/8	8-1/16	4-7/64	3-61/64	6-57/64	31/32	1-1/4	1-5/64	4.97
A17546	1-5/8	8-7/8	4-7/16	4-23/64	7-33/64	1-3/32	1-1/2	1-5/32	7.17
A17547	2-1/8	9-5/16	4-39/64	4-23/32	8-13/32	1-11/32	2	1-5/64	13.80
A17548	2-5/8	9-1/16	4-15/32	4-19/32	8-9/32	1-15/32	2	1-1/64	14.66
A17549	3-1/8	8-11/16	4-9/32	4-11/32	8-3/32	1-21/32	2	1-27/64	15.48

VALVES

MUELLER ACTUATED BALL VALVES

Specifications

Technical Data			
Actuator	Series I	Series II	Series III
Sizes	1/2 - 7/8	1-1/8 - 1-5/8	2-1/8 - 3-1/8
Torque (in.-lb)	44	132	310
Power Supply (VAC/DC)	24	24	24
Power Consumption (W)	2.3	2.3	6
Running Time (seconds)	90	125	150
Ambient Temperature (°F)	-22 to 130	-22 to 130	-22 to 130
Ball Valve			
Refrigerants	All Fluorinated Types		
Maximum Working Pressure (psig)	700 psig		
Working Temperature Range (°F)	-40 to 300° F		

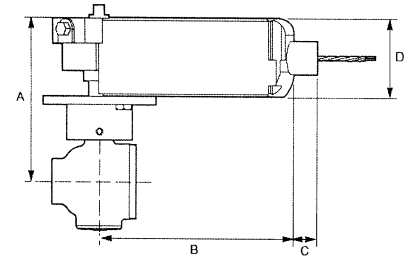

P4247A

*Load dependent.

**Does not depend on load.

Straight Thru Actuated Ball Valves

SIZE	STRAIGHT					3-WAY				
	Part No.	A	B	C	D	Part No.	E	F	G	H
1/2	AW17861	4.05	3.71	NA	2.69	AY17861	4.05	3.71	NA	2.69
5/8	AW17862	4.05	3.71	NA	2.69	AY17862	4.05	3.71	NA	2.69
3/4	AW17863	4.36	3.71	NA	2.69	AY17863	4.36	3.71	NA	2.69
7/8	AW17864	4.36	3.71	NA	2.69	AY17864	4.36	3.71	NA	2.69
1-1/8	AW17865	4.89	5.75	.65	3.18	AY17865	4.89	5.75	.65	3.18
1-3/8	AW17866	5.12	5.75	.65	3.18	A17810	5.70	5.75	.65	3.18
1-5/8	AW17867	5.84	5.75	.65	3.18	A17811	6.19	5.75	.65	3.18
2-1/8	AW17868	6.50	8.25	.67	3.93	A17812	6.50	8.25	.67	3.93
2-5/8	AW17871	6.50	8.25	.67	3.93	A17813	6.50	8.25	.67	3.93
3-1/8	AW17872	6.50	8.25	.67	3.93	A17814	6.50	8.25	.67	3.93

PACKED LINE VALVES

MUELLER PACKED LINE VALVES

TECHNICAL DATA

- Non-backseating service valves
- Forged brass body with integral mounting bracket
- Plated steel stem suitable for refrigerants and other industrial fluids non-corrosive to brass and steel
- Asbestos-free packing material
- Maximum pressure rating is 500 PSIG
- Maximum temperature rating at +300° F

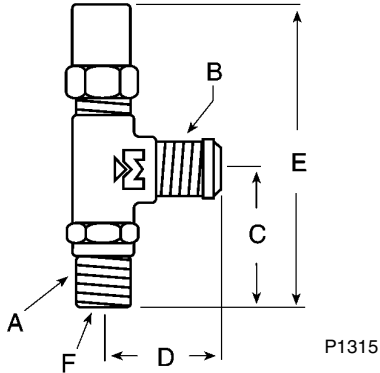

Angle Backseating - NPTFE Inlet to Flare

PART NO.	SIZE		C	D	E	COUNTERBORE DIMENSION (F*)		WT/EA.
	NPTFE A	Flare B				Dia.	Depth	
	A-13220	1/2						
A13183	1/2	5/8	1-13/16	1-1/2	4-11/16	.504	3/8	.64

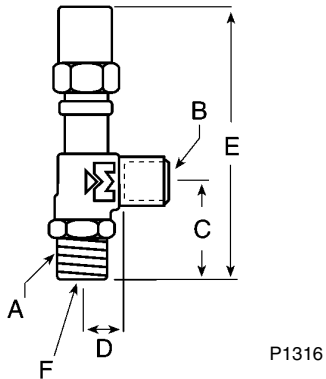

Angle Backseating - NPTFE Inlet to Solder

PART NO.	SIZE		C	D	E	COUNTERBORE DIMENSION (F*)		WT/EA.
	NPTFE A	Flare B				Dia.	Depth	
	A-13977	1/2						
A-13978	1/2	5/8	1-13/16	1	4-11/16	.504	3/8	.61
A-13979	3/4	7/8	2-3/32	1	6	.754	5/8	1.27

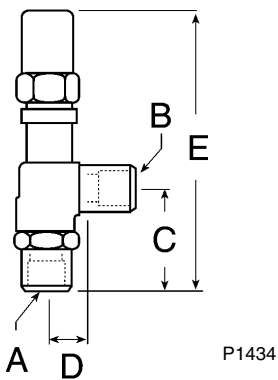

Angle Backseating - Solder to Solder

PART NO.	A	B	C	D	E	WT/EA.
A-17506	5/8	5/8	29/32	1	4-1/4	.66

PACKED LINE VALVES

MUELLER PACKED LINE VALVES (cont)

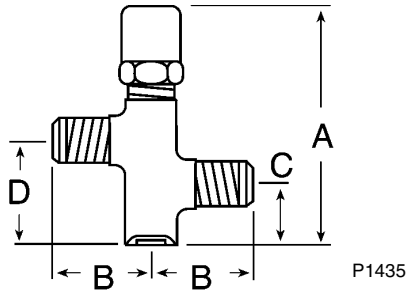

Two Way - Flare to Flare

PART NO.	SIZE	A	B	C	D	WT/EA.
A-13591	1/4	3-13/32	1	29/32	1-13/32	.50
A-13595	3/8	3-13/32	1-1/8	29/32	1-13/32	.55
A-13592	1/2	3-13/32	1-1/4	15/16	1-7/16	.56

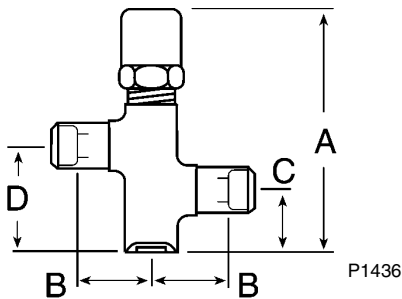

Two Way - Solder to Solder

PART NO.	SIZE	A	B	C	D	WT/EA.
A-15580	1/4	3-13/32	3/4	15/16	1-7/16	.49
A-15581	3/8	3-13/32	15/16	29/32	1-13/32	.51
A-15582	1/2	3-13/32	7/8	29/32	1-13/32	.52

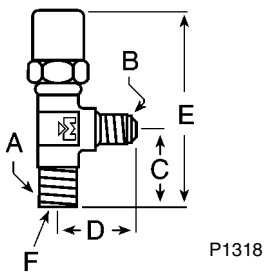

Angle Non-Backseating - NPTFE Inlet to Flare†

PART NO.	SIZE		FPT B	C	D	E	COUNTERBORE DIMENSIONS (F*)		WT/EA.
	MPT A	Flare B					Dia.	Depth	
A-11031	1/4	1/4	—	1	15/16	3-3/64	.254	5/16	.26
A-11030	1/4	3/8	—	1-1/16	1-1/8	3-3/32	.317	3/8	.31
A-13613	3/8	1/4	—	1-1/8	1-1/16	3-3/16	.379	3/8	.31
A-13503	3/8	3/8	—	1-1/8	1-1/8	3-3/32	.379	3/8	.33
A-11042	3/8	1/2	—	1-3/8	1-3/8	3-3/4	.379	3/8	.51
A-13502	1/4	—	1/4	1-3/8	1-1/16	3-13/16	.317	5/16	.48

*Machined to accept O.D. size tube as indicated.

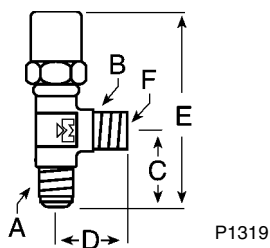

Angle Non-Backseating - Flare to NPTFE†

PART NO.	SIZE		C	D	E	COUNTERBORE DIMENSIONS (F*)		WT/EA.
	Flare A	MPT B				Dia.	Depth	
A-15073	1/4	1/4	15/16	1	3	.254	3/8	.27

*Machined to accept O.D. size tube as indicated.

PACKED LINE VALVES

MUELLER PACKED LINE VALVES (cont)

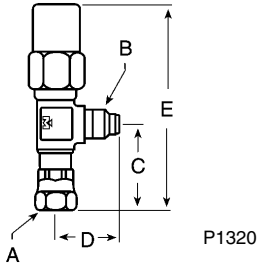

Angle Non-Backseating - Internal Swivel Flare to Flare

One soft copper gasket included with each assembly.

PART NO.	INTERNAL FLARE A	FLARE B	C	D	E	WT./EA.
A-17429	1/4	1/4	1-15/32	1-1/16	3-29/32	.33
A-17474	3/8	3/8	1-1/2	1-1/8	3-9/16	.27

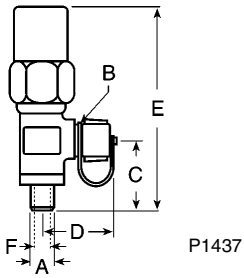

Angle Non-Backseating - Solder To Flare With Seal Cap

PART NO.	SOLDER A	FLARE B	C	D	E	WT./EA.
A-17502	1/4*	1/4	23/32	1-1/32	3-3/64	.58
A-17503	3/8**	3/8	9/16	1-1/2	3-1/64	.49

*Also 3/8 FTG.

**Also 1/2 FTG.

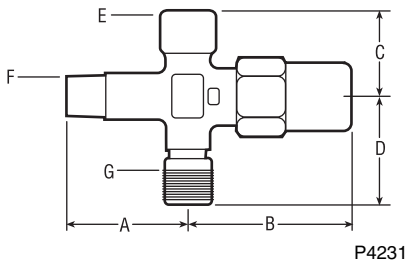

Transducer Valve

PART NO.	A	B	C	D	E	F	G	STEM CAP MATERIAL
B 33837	1-1/2	2	1	1-1/4	1/8 NPTF	1/4 NPTF	1/4 Flare Access	Steel
B 34254	1-1/2	2	1	1-1/4	1/8 NPTF	1/4 NPTF	1/4 Flare Access	Brass

DIAPHRAGM VALVES

MUELLER PACKLESS DIAPHRAGM VALVES

Specifications

Technical Data	
Refrigerants	All fluorinated types
Working Temperature Range	-40° F/+300° F
Maximum Working Pressure	500 psig with flow in the direction of the arrow on the body 350 psig with flow against the direction of the arrow
Burst Pressure	2500 psig

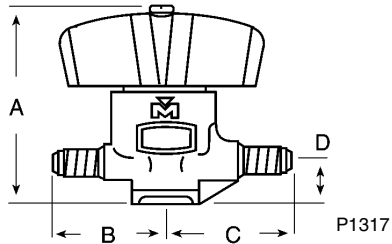

Straight Thru - Flare to Flare - Type I - Class IV

PART NO.	SIZE	A OPEN	B	C	D	WT/EA.
A-14833	1/4	2-11/16	1-5/16	1-3/8	5/8	.75
A-14835	3/8	2-11/16	1-3/8	1-27/64	5/8	.76
A-14836	1/2	3-15/32	1-5/8	1-27/32	27/32	1.25
A-14837	5/8	3-15/32	1-11/16	1-15/16	27/32	1.27

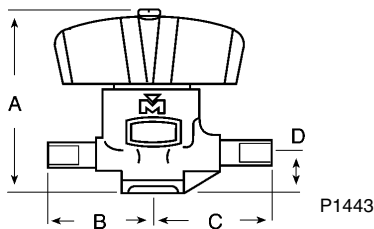

Straight Thru - Solder to Solder - Type I - Class II

PART NO.	SIZE	A OPEN	B	C	D	WT/EA.
A-14838	1/4	2-11/16	1-1/32	1-3/32	5/8	.72
A-14840	3/8	2-11/16	1-1/32	1-3/32	5/8	.71
A-14841	1/2	3-1/2	1-5/16	1-9/16	27/32	1.22
A-14842	5/8	3-1/2	1-13/64	1-7/16	27/32	1.22

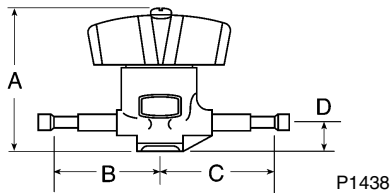

Extended End - Solder to Solder - Type I - Class II

PART NO.	SIZE	A OPEN	B	C	D	WT/EA.
A-14848	1/4	2-11/16	2-21/36	2-23/32	5/8	.75
A-14850	3/8	2-11/16	2-13/16	2-7/8	5/8	.76
A-14851	1/2	3-1/2	3-1/32	3-11/32	27/32	1.28
A-14852	5/8	3-1/2	3-7/64	3-11/32	27/32	1.34

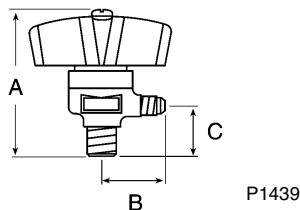

Angle - NPTFE to Flare - Type I

PART NO.	SIZE		OPEN A	B	C	WT/EA..
	MPT	Flare				
A-15525	1/4	1/4	2-13/16	1-19/64	1-3/64	.61
A-15526	1/4	3/8	2-13/16	1-27/64	1-3/64	.63
A-15527	3/8	1/4	2-7/8	1-19/64	1-5/64	.62
A-15528	3/8	3/8	2-7/8	1-27/64	1-5/64	.64
A-15529	3/8	1/2	3-9/16	1-27/32	1-19/64	1.06
A-15530	1/2	1/2	3-11/16	1-27/32	1-7/16	1.06
A-15531	1/2	5/8	3-11/16	1-15/16	1-7/16	1.08

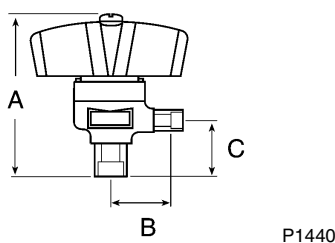

Angle - Solder to Solder - Type I - Class I

PART NO.	SIZE		OPEN A	B	C	WT/EA.
	O.D.	O.D.				
A-15539	1/4	1/4	2-27/32	1-3/32	3/4	.69
A-15540	3/8	3/8	2-27/32	1-3/32	3/4	.71
A-15541	1/2	1/2	3-11/16	1-3/16	1-1/16	1.14
A-15542	5/8	5/8	3-11/16	15/16	15/16	1.14

PRESSURE RELIEF VALVES

MUELLER PRESSURE RELIEF VALVES

SPECIFICATIONS

PSIG	Prefix	DISCHARGE CAPACITY												TYPE OF REFRIGERANT	
		A		B		C		D		E		F		Refrigerant	Value of f
		lb air/min	kg air/min	lb air/min	kg air/min	lb air/min	kg air/min	lb air/min	kg air/min	lb air/min	kg air/min	lb air/min	kg air/min		
235	AD	4.3	2.0	9.1	4.1	20.1	9.1	33.7	15.3	55.9	25.4	91.8	41.6	R-11, R-113, R-123	1
300	AE	5.4	2.4	11.5	5.2	25.4	11.5	42.5	19.3	70.5	32.0	115.8	52.5	R-12, R-22, R-134a, R-407c, R-500	1.6
350	AG	6.3	2.9	13.3	6.0	29.5	13.4	49.3	22.4	81.8	37.1	134.3	60.9		
400	AH	7.1	3.2	15.2	6.9	33.5	15.2	56.1	25.4	93.0	42.2	152.7	69.3	R-13, R-13b1	2.0
425	AI	7.6	3.4	16.1	7.3	35.6	16.1	59.5	27.0	98.6	44.7	162.0	73.5	R-404A, R-502, R-507a	2.5
450	JA	8.0	3.6	17.0	7.7	37.6	17.1	62.9	28.5	104.3	47.3	171.2	77.7		

Straight Thru — NPTFE Inlet to Flare

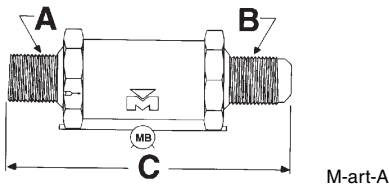

M-art-A

ASME VALVE	INLET (A) (in.)	OUTLET (B) (in.)	(C)		WT. EACH		DISCHARGE TABLE
			(in.)	(cm)	(lb)	(kg)	
A 15501	1/4	3/8	2-21/32	6.75	0.19	0.09	A
A 15502	3/8	3/8	2-13/16	7.14	0.33	0.15	B
A 15503	3/8	1/2	3	7.62	0.36	0.16	B
A 15504	1/2	5/8	4-3/16	10.64	0.84	0.38	C
A 15506	3/4	3/4	5	12.70	1.49	0.68	D
B 33752	1/4	3/8	2-13/16	7.14	0.32	0.14	B
B 33753	1/4	1/2	3	7.62	NA	NA	B

Angle — NPTFE to Flare

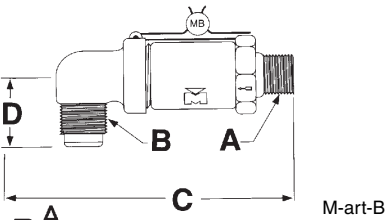

M-art-B

ASME VALVE	INLET (A) (in.)	OUTLET (B) (in.)	(C)		(D)		WT. EACH		DISCHARGE TABLE
			(in.)	(cm)	(in.)	(cm)	(lb)	(kg)	
B 33746	1/4	3/8	2-3/8	6.03	1-1/8	2.86	0.30	0.14	B
B 33754	1/4	1/2	2-7/16	6.19	1-5/16	3.33	NA	NA	B
A 15512	3/8	3/8	2-3/8	6.03	1-3/8	3.49	0.36	0.16	B
A 15513	3/8	1/2	2-3/8	6.03	1-11/32	3.41	0.38	0.17	B
A 15514	1/2	5/8	4-3/32	10.40	1-9/16	3.97	0.98	0.45	C

Atmospheric — NPTFE Inlet

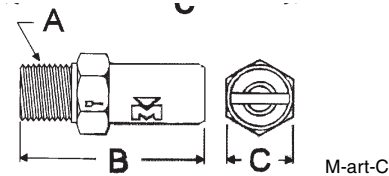

M-art-C

ASME VALVE	INLET (A) (in.)	OUTLET (B) (in.)	(C)		WT. EACH		DISCHARGE TABLE
			(in.)	(cm)	(lb)	(kg)	
A 15508	1/8	1-7/8	3/4	1.91	0.12	0.05	A
A 15509	1/4	2	3/4	1.91	0.13	0.06	A
A 17430	3/8	2-1/8	1	2.54	0.24	0.11	B
B 33755	1/4	2-1/8	1	2.54	NA	NA	B

Straight Thru — NPTFE Inlet to NPTFI Outlet

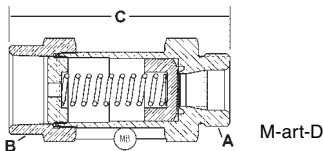

M-art-D

ASME VALVE	INLET (A) (in.)	OUTLET (B) (in.)	(C)		WT. EACH		DISCHARGE TABLE
			(in.)	(cm)	(lb)	(kg)	
A 17840	1	1	4-9/16	11.59	1.95	0.88	E
A 17834	1-1/4	1-1/4	5	12.70	2.00	0.91	F

Straight Thru-Straight Thread Inlet to NPTFI Outlet

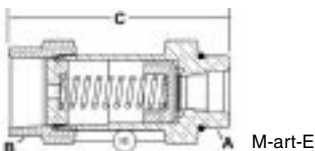

M-art-E

ASME VALVE	INLET (A) (in.)	OUTLET (B) (in.)	(C)		WT. EACH		DISCHARGE TABLE
			(in.)	(cm)	(lb)	(kg)	
B 34444	7/8-14 UNF 2A	3/4	7/8	2.22	1.53	0.69	D
B 34519	1-5/16-14 UNF 2A	1	4-3/8	11.11	1.37	0.62	E
B 34580	1-5/8-14 UNF 2A	1-1/4	5	12.70	2.00	0.91	F

Prefixes for standard settings are:

AD = 235 psig, AE = 300 psig, AG = 350 psig, AH = 400 psig, AI = 425 psig, AJ = 450 psig

ISOLATION VALVES

MUELLER ANGLE ISOLATION VALVES

Specifications

TECHNICAL DATA										
Part No.	B-34413	B-34412	B-34411	B-34594	B-34595	B-34418	B-34417	B-34416	B-34415	B-34414
Torques to Seal (ft-lb)										
Front Seat	16-18	22-40	22-40	22-40	22-40	16-18	22-40	22-40	22-40	22-40
Back Seat	16-18	25-45	25-45	25-45	25-45	16-18	25-45	25-45	25-45	25-45
Pack Gland	8-12	15-25	15-25	15-25	15-25	8-12	15-25	15-25	15-25	15-25
Flare Seal Cap	8-10	8-10	15-25	15-25	15-25	8-10	8-10	15-25	15-25	15-25
Rotolock Nut	NA	NA	NA	NA	NA	40-50	60-80	60-80	60-80	80-100
Seal Cap	Finger Tight			40-50	40-50	Finger Tight			40-50	40-50
Maximum Working Pressure (psig)	500	500	50	500	500	500	500	500	500	500
Burst Pressure (psig)	2500	2500	2500	2500	2500	2500	2500	2500	2500	2500
Working Temperature Range (°F)	-40/300	-40/300	-40/300	-40/300	-40/300	-40/300	-40/300	-40/300	-40/300	-40/300
Refrigerants	All Fluorinated Types									

Solder X Solder Angle Isolation Valve

PART NO.	SIZE	TYPE	Cv	A	B	C	D	E	F
B-34413	5/8	5/8 ODS x 5/8 ODS	6	5-27/64	2-21/32	27/32	1-11/64	1/2	1/2
B-34412	7/8	7/8 ODS x 7/8 ODS	15	6-9/16	3-3/32	29/32	1-17/64	3/4	3/4
B-34411	1-1/8	1-1/8 ODS x 1-1/8 ODS	25	7-19/32	3-63/64	1-5/16	1-1/2	15/16	15/16
B-34594	1-3/8	1-3/8 ODS x 1-3/8 ODS	38	9-31/64	4-3/16	1-1/2	1-29/32	1	1
B-34595	1-5/8	1-5/8 ODS x 1-5/8 ODS	53	10-3/64	4-11/16	1-3/4	2-3/16	1-3/32	1-3/32

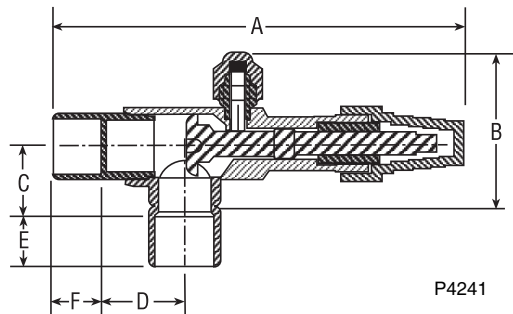

Solder X Rotolock Angle Isolation Valve

PART NO.	SIZE	TYPE	Cv	A	B	C	D	E	F	G
B-34418	5/8	5/8 ODS x 1 THD	6	5-27/64	2-1/4	35/64	15/16	35/64	11/64	1/2
B-34417	7/8	7/8 ODS x 1-1/4 THD	15	6-9/16	2-31/64	3/4	1-3/64	3/4	1-17/64	3/4
B-34416	1-1/8	1-1/8 ODS x 1-1/2 THD	25	7-19/32	3	1	1-1/4	1	1-33/64	15/16
B-34415	1-3/8	1-3/8 ODS x 1-3/4 THD	38	9-33/64	3-17/64	1-1/4	1-13/32	1-1/4	1-29/32	1
B-34414	1-5/8	1-5/8 ODS x 2-1/4 THD	53	10-3/64	3-35/64	1-1/2	1-9/16	1-1/2	2-3/16	1-3/32

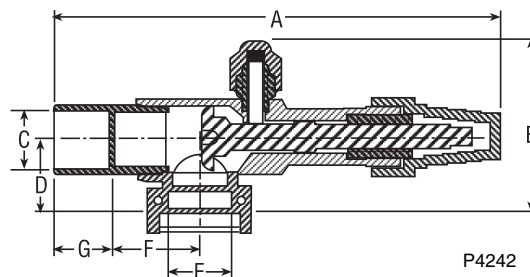

CHANGEOVER MANIFOLD

MUELLER CHANGEOVER MANIFOLD

Specifications

PART NO.	INLET	OUTLETS	A (In.)	B (in.)	C (in.)	D (in.)	E (in.)	F (in.)
A-17921	1/2 NPTFE	1/2 NPTFI	6	1-3/4	1-3/4	1-3/8	2-1/16	3/4
A-17922	3/4 NPTFE	3/4 NPTFI	6	1-3/4	1-7/8	1-3/8	2-1/16	3/4
A-17923	1 NPTFE	1 NPTFI	8-11/16	2-7/16	2-3/8	1-7/8	3-1/8	1-7/16
A-17924	1-1/4 NPTFE	1-1/4 NPTFE	8-7/8	2-7/16	2-7/16	2-1/8	3-1/8	1-7/16
B-34550	7/8-14 UNF 2A	7/8-14 UNF 2B	6	1-3/4	1-5/8	1-3/8	2-1/16	3/4
B-34559	1-5/16-12 UNF 2A	1-5/16-12 UNF 2B	8-9/16	2-7/16	2-1/8	1-3/4	3-1/8	1-7/16
B-34654	1-5/8-12 UNF 2A	1-5/8-12 UNF 2B	8-9/16	2-7/16	2-1/8	1-13/16	3-1/8	1-7/16

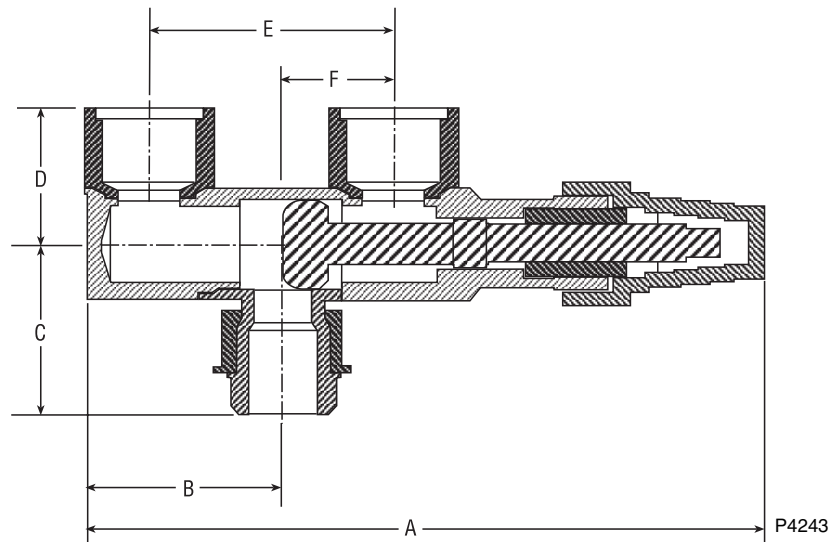

COMPRESSOR VALVE KITS

MUELLER COMPRESSOR VALVE KITS

Specifications

TECHNICAL DATA							
KIT PART NO.	A-17518	A-17519	A-17520	A-17510	A-17511	A-17512	A-17531
Maximum Working Pressure (psig)	500	500	500	500	500	500	500
Burst Pressure (psig)	2500	2500	2500	2500	2500	2500	2500
Working Temperature Range (°F)	-40/300	-40/300	-40/300	-40/300	-40/300	-40/300	-40/300
Fluid Compatibility	All Fluorinated Types						
Torques To Seal							
Front Seat (ft-lb)	14-18	14-18	14-18	14-18	14-18	14-18	14-18
Back Seat (ft-lb)	14-18	14-18	14-18	14-18	14-18	14-18	14-18
Pack Gland (ft-lb)	8-12	8-12	8-12	8-12	8-12	8-12	8-12
Pipe Plug (ft-lb)	2-3 Threads Exposed						
Seal Cap (ft-lb)							
Plastic	NA						
Brass	20-30	20-30	20-30	20-30	20-30	20-30	20-30
Steel	3-5	3-5	3-5	3-5	3-5	3-5	3-5

NOTE: Each kit includes valve body, cap, gaskets, and bolts to perfectly match compressor.

Double Port — 45° Flare Type

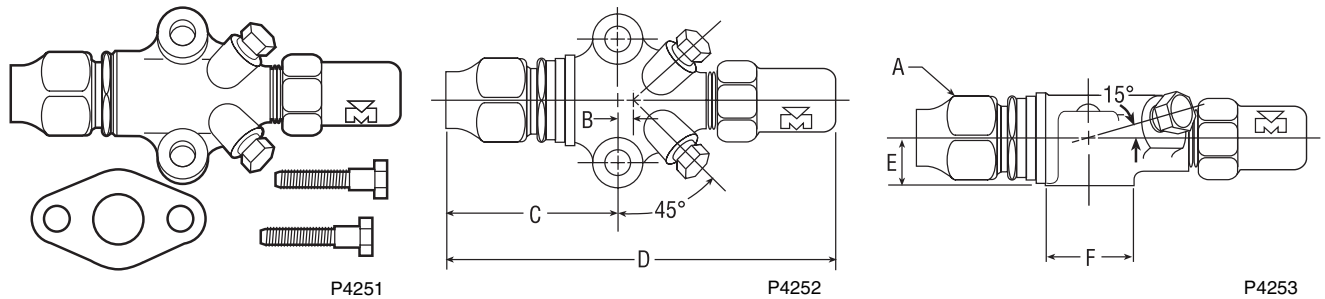

Double Port — 45° Flare Type — Forged Brass Body

KIT PART NO.	FLARE SIZE A	B	C	D	E	F	BOLT CENTERS	DIA. BOLT HOLES	PIPE PLUG SIZE	FLANGE THICKNESS	COPELAND NO.
A-17518	3/8	9/32	1-3/4	4-9/16	5/8	1-1/4	1-5/8	11/32	1/8	7/8	998-0510-15
A-17519	1/2	9/32	1-7/8	4-11/16	5/8	1-1/4	1-5/8	11/32	1/8	7/8	998-0510-16
A-17520	5/8	9/32	2	4-13/16	5/8	1-1/4	1-5/8	11/32	1/8	7/8	998-0510-17

Double Port

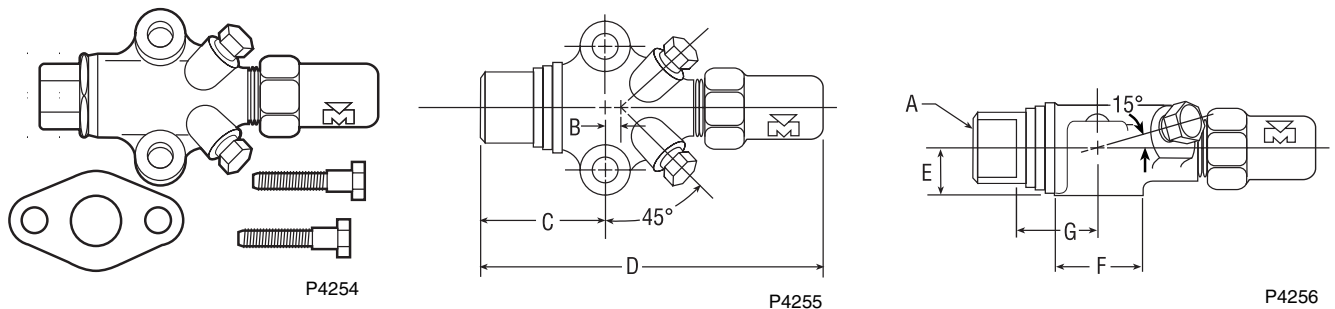

Double Port — Solder Type — Forged Brass Body

KIT PART NO.	FLARE SIZE A	B	C	D	E	F	G	BOLT CENTERS	DIA. BOLT HOLES	PIPE PLUG SIZE	FLANGE THICKNESS	COPELAND NO.
A-17510	3/8	9/32	1-9/32	4-3/32	5/8	1-1/4	31/32	1-5/8	11/32	1/8	7/8	998-0510-04
A-17511	1/2	9/32	1-13/32	4-3/32	5/8	1-1/4	1-1/32	1-5/8	11/32	1/8	7/8	998-0510-05
A-17512	5/8	9/32	1-17/32	4-11/32	5/8	1-1/4	1-1/32	1-5/8	11/32	1/8	7/8	998-0510-06

COMPRESSOR VALVE KITS

MUELLER COMPRESSOR VALVE KITS

Specifications

TECHNICAL DATA

KIT PART NO.	A-17513	A-17514	A-17521	A-17522	A-17523	A-17524	A-17535	A-17532	A-17555	A-17534
Maximum Working Pressure (psig)	500	500	500	500	500	500	500	500	500	500
Burst Pressure (psig)	2500	2500	2500	2500	2500	2500	2500	2500	2500	2500
Working Temperature Range (°F)	-40/300	-40/300	-40/300	-40/300	-40/300	-40/300	-40/300	-40/300	-40/300	-40/300
Fluid Compatibility	All Fluorinated Types									
Torques To Seal										
Front Seat (ft-lb)	45-65	45-65	45-70	45-70	45-65	45-65	45-65	22-40	22-40	22-40
Back Seat (ft-lb)	45-65	45-65	45-65	45-65	45-65	45-65	45-65	25-45	25-45	25-45
Pack Gland (ft-lb)	25-35	25-35	55-70	55-70	35-45	35-45	35-45	10-15	10-15	10-15
Pipe Plug (ft-lb)	2-3 Threads Exposed									
Seal Cap (ft-lb)										
Plastic	Hand Tight									
Cast Iron	Hand Tight									

NOTE: Each kit includes valve body, cap, gaskets, and bolts to perfectly match compressor.

Flanged Union Style

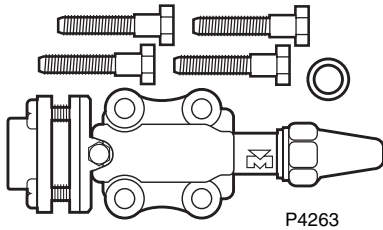

P4263

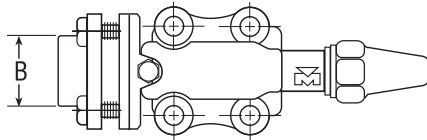

P4264

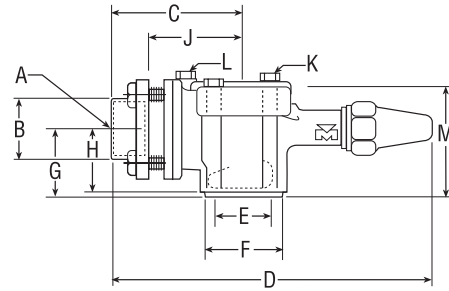

P4265

Flanged Union Style — Solder Type — Cast Iron Valve Body

KIT PART NO.	TUBE SIZE A	B	C	D	E	F	G	H	J	K	L	M	BOLT CENTERS	DIA BOLT HOLES	COPELAND
A-17513	1-5/8	2-1/8	4-17/32	10-1/16	2-1/8	2-3/4	1-13/16	1-17/32	3-3/16	1/4	1/4	2-11/16	2-1/2	17/32	998-0510-07
A-17514	1-3/8	2-1/8	4-17/32	9-15/16	2-1/8	2-3/4	1-13/16	1-17/32	3-7/16	1/4	1/4	2-11/16	2-1/2	17/32	998-0510-08
A-17521	3-1/8	3-7/8	6-1/2	14-13/32	3-11/32	4-5/32	2-1/4	2	4-27/32	1/4	1/4	4-21/32	2-5/8	11/16	998-0510-18
A-17522	2-5/8	3-7/8	6-1/2	15	3-11/32	4-5/32	2-1/4	2	4-3/16	1/4	1/4	4-5/8	3-7/8	11/16	998-0510-19
A-17523	2-1/8	3-1/16	5-1/16	11-15/16	2-17/32	3-7/32	2-3/8	2-3/16	3-3/4	1/4	1/4	3-7/16	3-1/16	11/16	998-0510-20
A-17524	1-5/8	3-1/16	5-1/4	12-1/8	2-17/32	3-7/32	2-3/8	2-3/16	4-5/32	1/4	1/4	3-7/16	3-1/16	11/16	998-0510-21

COMPRESSOR VALVE KITS

MUELLER COMPRESSOR VALVE KITS

Specifications

TECHNICAL DATA									
KIT PART NO.	A-17515	A-17516	A-17517	A-17528	A-17529	A-17530	A-17525	A-17526	A-17527
Maximum Working Pressure (psig)	500	500	500	500	500	500	500	500	500
Burst Pressure (psig)	2500	2500	2500	2500	2500	2500	2500	2500	2500
Working Temperature Range (°F)	-40/300	-40/300	-40/300	-40/300	-40/300	-40/300	-40/300	-40/300	-40/300
Fluid Compatibility	All Fluorinated Types								
Torques To Seal									
Front Seat (ft-lb)	22-40	22-40	22-40	22-40	22-40	22-40	30-40	30-40	30-40
Back Seat (ft-lb)	25-45	25-45	25-45	25-45	25-45	25-45	22-45	22-45	22-45
Pack Gland (ft-lb)	15-25	15-25	15-25	15-25	15-25	15-25	15-25	15-25	15-25
Pipe Plug (ft-lb)	2-3 Threads Exposed								
Seal Cap (ft-lb)									
Plastic	Hand Tight								
Brass	NA	NA	NA	NA	40-50	NA	40-50	40-50	40-50
Steel	NA								

NOTE: Each kit includes valve body, cap, gaskets, and bolts to perfectly match compressor.

Straight Port

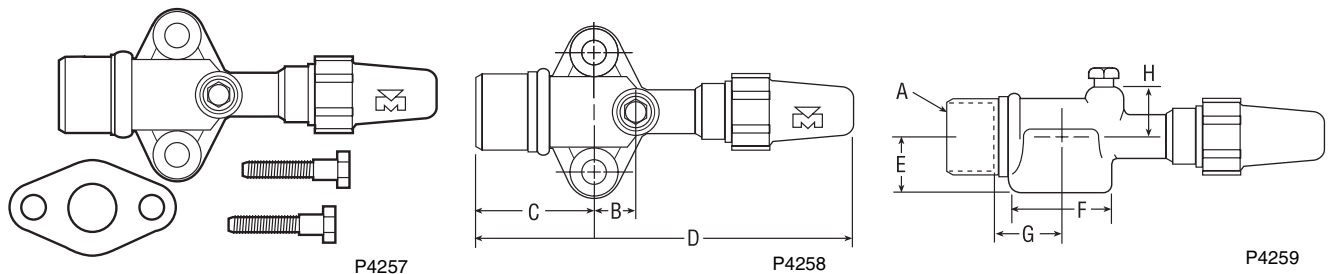

Straight Port — Solder Type — Forged Brass Body

KIT PART NO.	FLARE SIZE A	B	C	D	E	F	G	H	BOLT CENTERS	DIA. BOLT HOLES	PIPE PLUG SIZE	FLANGE THICKNESS	COPELAND NO.
A-17515	7/8	3/4	1-31/32	6-9/16	7/8	1-1/2	1-7/32	1	1-5/8	11/32	1/8	1-21/64	998-0510-12
A-17516	1-1/8	3/4	2-1/16	6-11/16	7/8	1-1/2	1-5/32	1	1-5/8	11/32	1/8	1-21/64	998-0510-13
A-17517	3/4	3/4	1-29/32	6-1/2	7/8	1-1/2	1-9/32	1	1-5/8	11/32	1/8	1-21/64	998-0510-14

Flanged Union Style

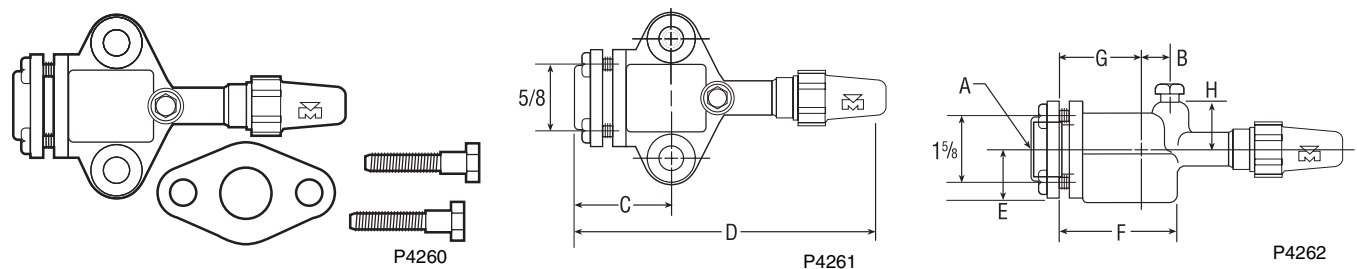

Flanged Union Style — Solder Type — Forged Brass Body

KIT PART NO.	FLARE SIZE A	B	C	D	E	G	H	BOLT CENTERS	DIA. BOLT HOLES	PIPE PLUG SIZE	FLANGE THICKNESS	COPELAND NO.
A-17525	1-1/8	1	2-15/32	7-1/2	1-1/4	1-9/16	1-1/8	2-3/4	17/32	1/8	1	998-0510-09
A-17526	1-3/8	1	2-15/32	7-1/2	1-1/4	1-1/2	1-1/8	2-3/4	17/32	1/8	1	998-0510-11
A-17527	7/8	1	2-5/16	7-11/32	1-1/4	1-9/16	1-1/8	2-3/4	17/32	1/8	1	998-0510-10

FUSIBLE CONNECTORS

MUELLER FUSIBLE CONNECTORS

Fusible Connectors — Half Union — Flare to NPTFE

Listed by Underwriters Laboratories, Inc., for use in the USA and Canada

Part No.	Old Part No.	Size			A	B	C	D	Melting Temp* (°F)	Per Ctn.	Wt/Ea.
		Flare	NPTFE	Hex							
FU-4B-*	A-14062	1/4	1/4	9/16	3/16	1-1/4	9/16	3/16	283	10	.07
FU-4C-*	A-14063	1/4	3/8	11/16	3/16	1-5/16	9/16	1/4	283	10	.09
FU-6C-*	A-14064	3/8	3/8	11/16	9/32	1-7/16	9/16	1/4	283	10	.12
FU-4B-*	A-14023	1/4	1/4	9/16	3/16	1-1/4	9/16	3/16	210	10	.06
FU-4C-*	A-14025	1/4	3/8	11/16	3/16	1-5/16	9/16	1/4	210	10	.09
FU-6C-*	A-14026	3/8	3/8	11/16	9/32	1-7/16	9/16	1/4	210	10	.12
FU-4B-*	A-14024	1/4	1/4	9/16	3/16	1-1/4	9/16	3/16	168	10	.06
FU-4C-*	A-14050	1/4	3/8	11/16	3/16	1-5/16	9/16	1/4	168	10	.09
FU-6C-*	A-14027	3/8	3/8	11/16	9/32	1-7/16	9/16	1/4	168	10	.13

*Melting Temperature Equivalents — 283° F (139° C), 210° F (99° C), 168° F (76° C).

ex) FU-4B-283

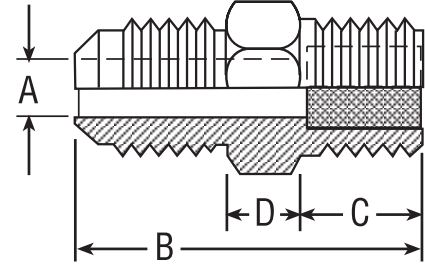

P4239

Fusible Pipe Plugs

Listed by Underwriters Laboratories, Inc., for use in the USA and Canada

Part No.	Old Part No.	Size		A	B	Melting Temp* (°F)	Pcs, Per Ctn.	Wt/Ea.
		NPTFE	Hex					
FP-A-*	A-14058	1/8	7/16	7/32	19/32	283	10	.02
FP-B-*	A-14059	1/4	9/16	1/4	25/32	283	15	.05
FP-C-*	A-14060	3/8	11/16	3/8	27/32	283	15	.08
FP-A-*	A-14017	1/8	7/16	7/32	19/32	210	10	.03
FP-B-*	A-14018	1/4	9/16	1/4	25/32	210	15	.05
FP-C-*	A-14021	3/8	11/16	3/8	27/32	210	15	.06
FP-A-*	A-15214	1/8	7/16	7/32	19/32	168	10	.02
FP-B-*	A-14019	1/4	9/16	1/4	25/32	168	15	.04
FP-C-*	A-14022	3/8	11/16	3/8	27/32	168	15	.06

*Melting Temperature Equivalents — 283° F (139° C), 210° F (99° C), 168° F (76° C).

ex) FP-A-283

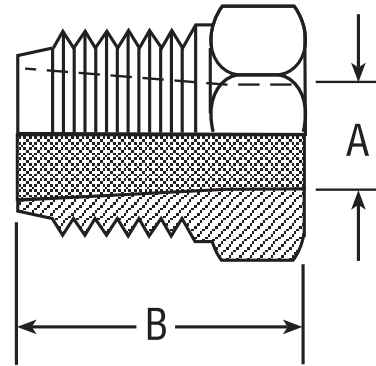

P4240